

BOOK OF DRAWINGS FOR PROPOSED KATSANGAI WATER SUPPLY PROJECT

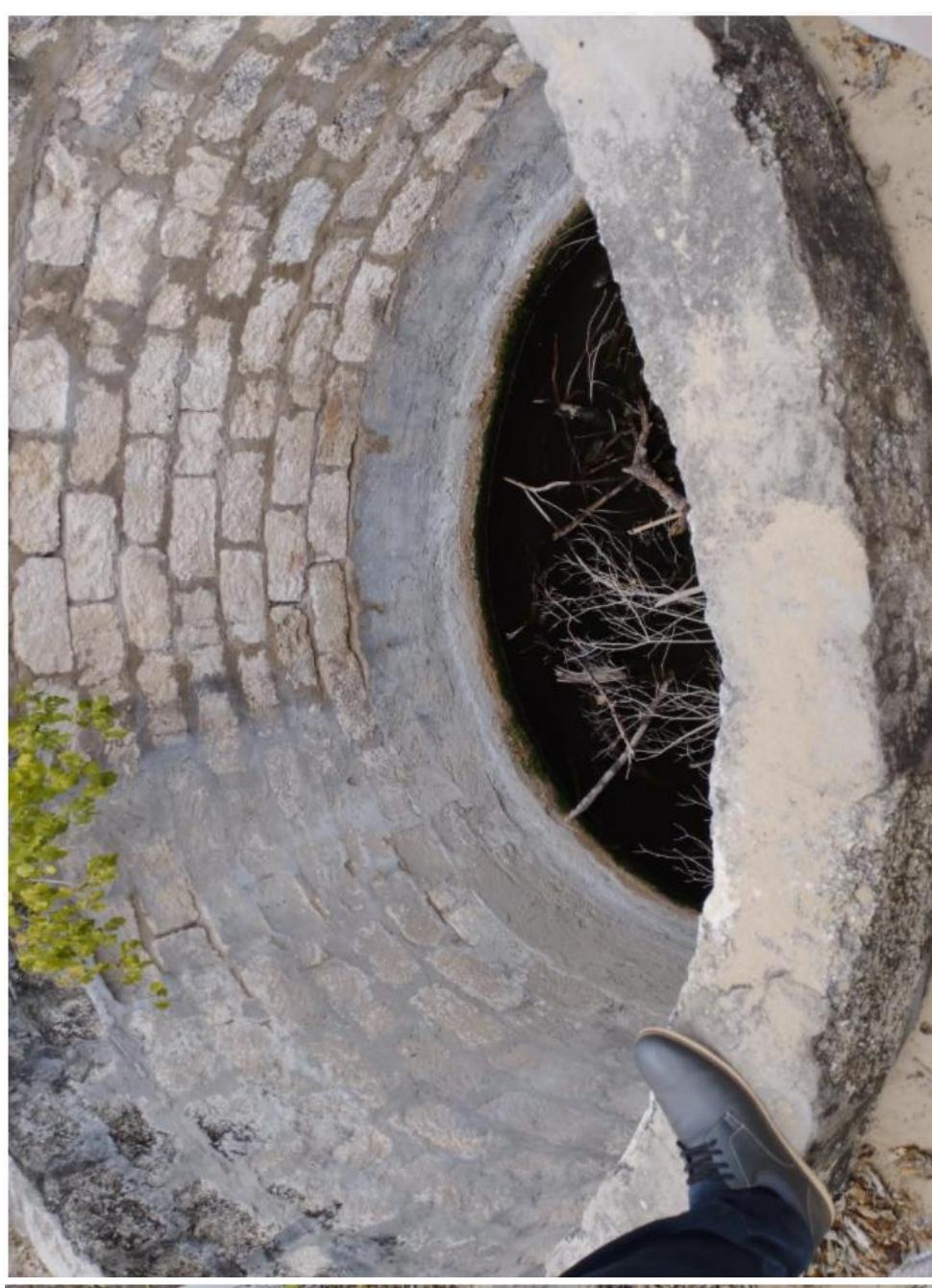

INTERNATIONAL COMMITTEE
FOR DEVELOPMENT OF PEOPLE
NAIROBI OFFICE # 117
MANYANI EAST ROAD, OFF
JAMES GICHURU, LAVINGTON,
NAIROBI , KENYA
Email: kenya@cisp-ngo.org

CHAINAGE: 0+000 TO 0+500

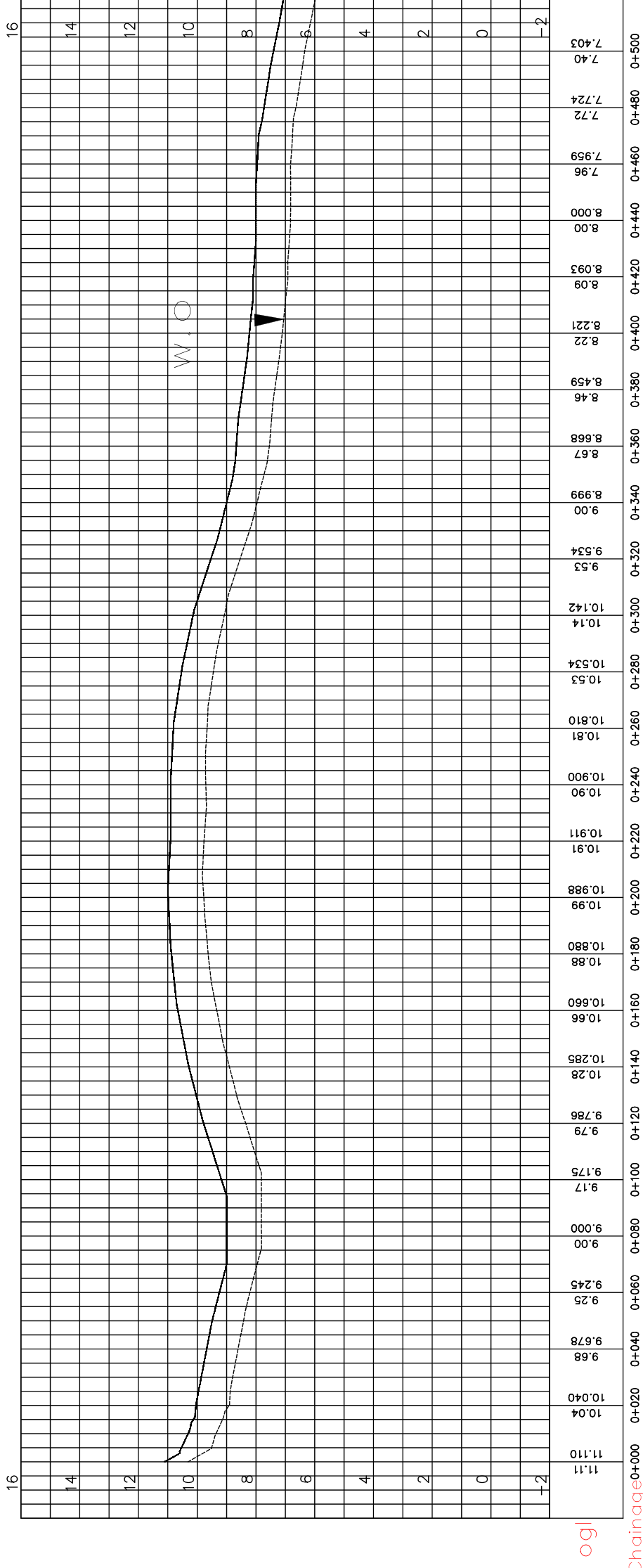

Pipe 55mm, Dia at 0.8m min. depth.
 HDPE, 12.5 PN

CHAINAGE: 0+500 TO 1+000

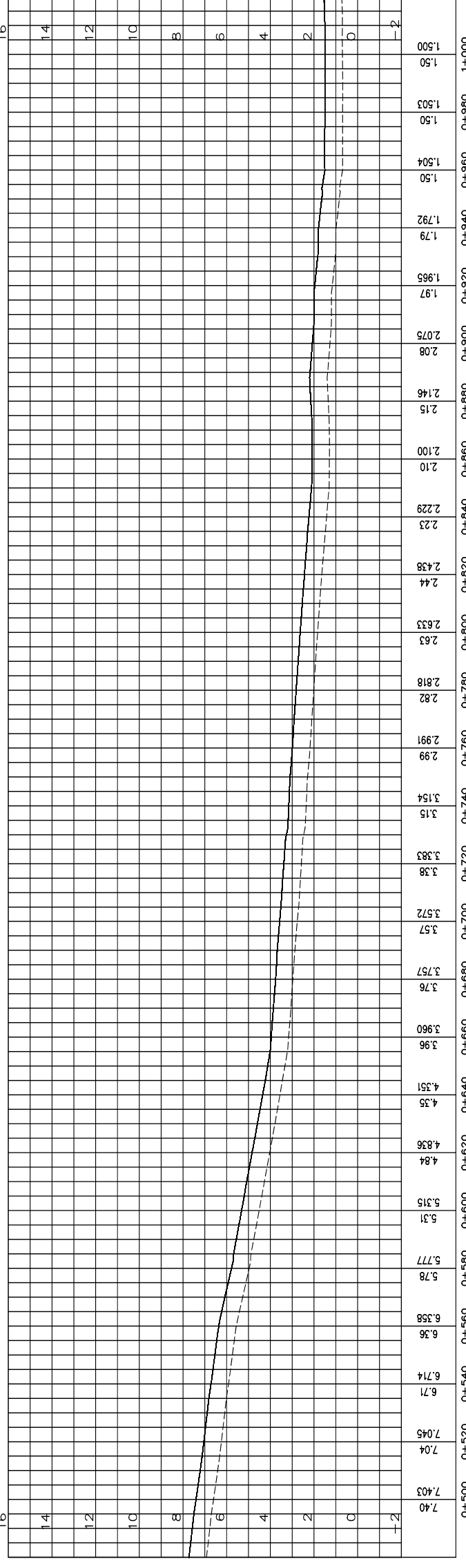

Pipe 55mm Dia, at 0.8m min. depth.

NOTES:

- All Levels are in metres based on National Datum
- All dimensions are in meters unless otherwise specified.

LEGEND:-



SURVEY BENCHMARK

NO	REVISION	BY	CHKD	DATE
4				
3				
2				
1				

PROJECT:
 WASH-COMMUNITY RESILIENCE BUILDING IN LIVELIHOOD & DISASTER RISK MANAGEMENT (REBUILD) IN TANA-RIVER COUNTY

CISP
 INTERNATIONAL COMMITTEE FOR DEVELOPMENT OF PEOPLE
 NAIROBI OFFICE # 117
 MANYANI EAST ROAD, OFF JAMES GICHURU, LIVINGSTON, NAIROBI, KENYA
 Email: kenya@cisp-ngo.org

INDIVIDUAL CONSULTANT
 ENG. JMR
 P.O BOX 72398-0200
 Nairobi, KENYA
 Telephone: +254 - 722617042 Email: rameso@yahoo.com

Pipeline Profile

CHAINAGE: 1+000 TO 1+500

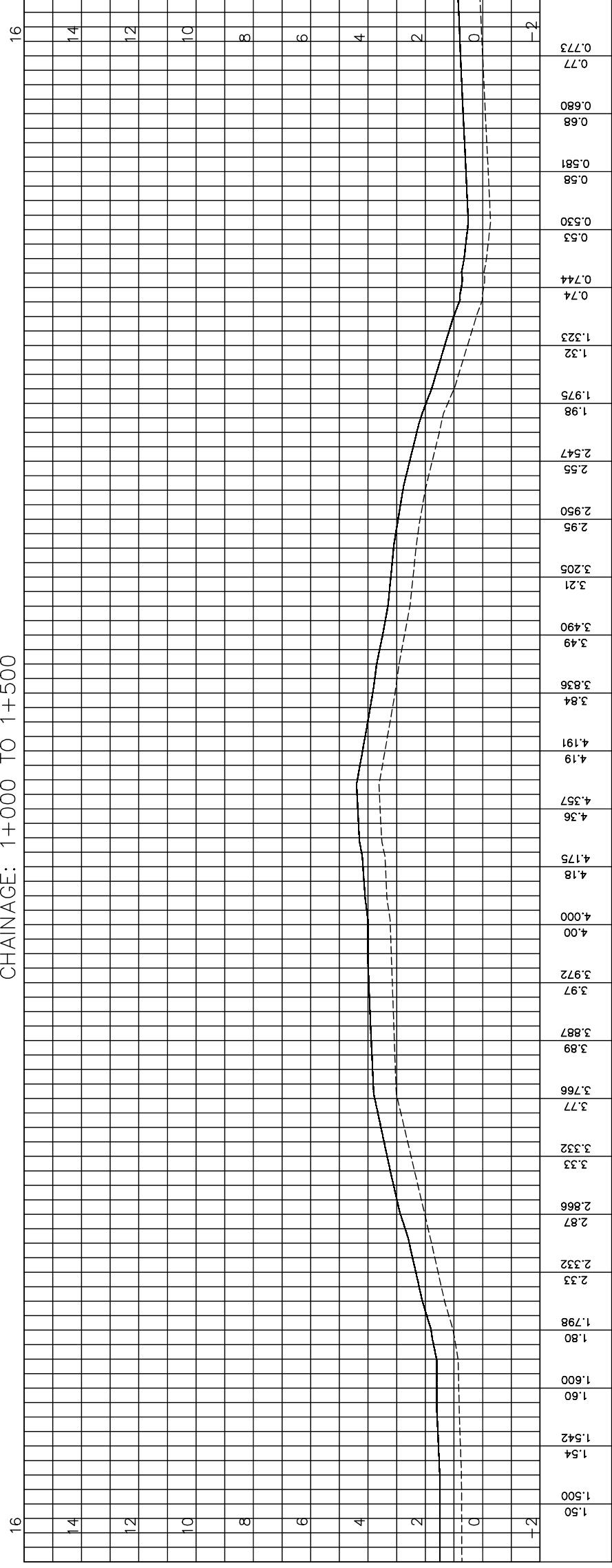

Pipe 55mm Dia, at 0.8m min. depth.

CHAINAGE: 1+500 TO 2+000

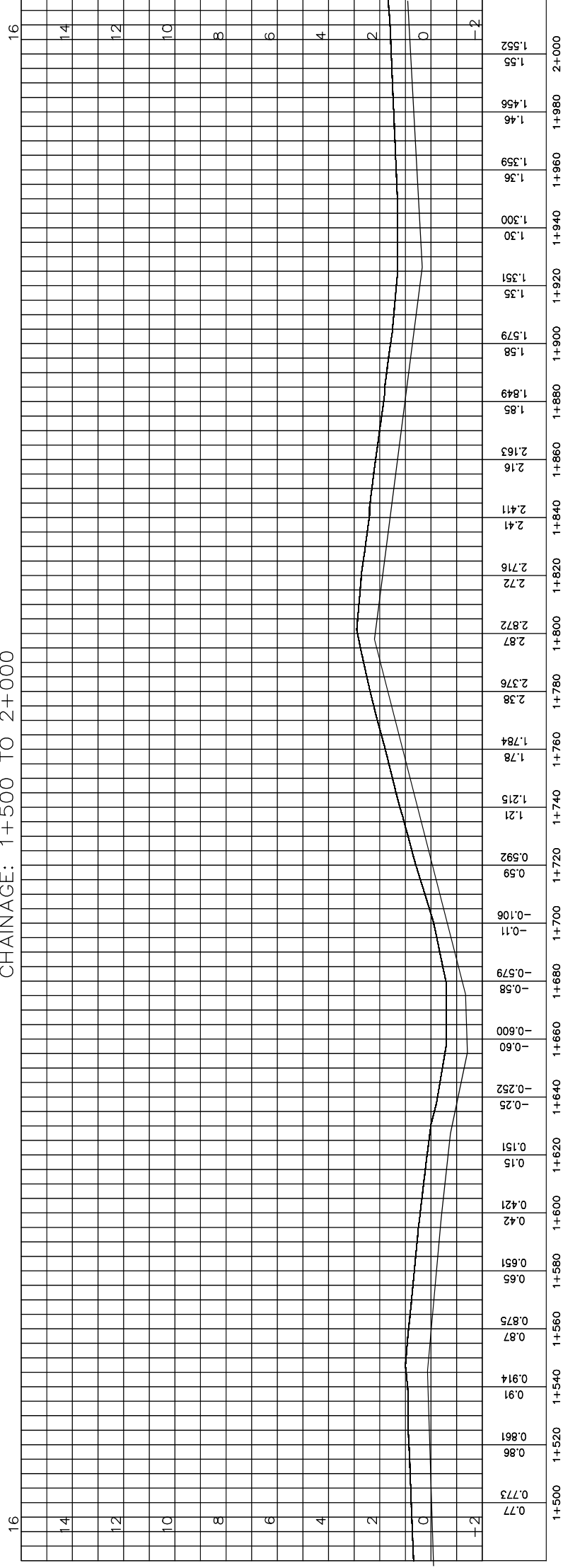

Pipe 55mm Dia, at 0.8m min. depth.

NOTES:

- All Levels are in metres based on National Datum
- All dimensions are in meters unless otherwise specified.

LEGEND:-

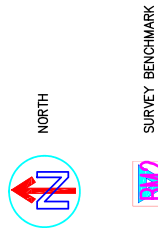

REV	REVISIONS	SR	DATE	APPROVED
4	BY			
3	BY			
2	BY			
1	BY			

PROJECT: WASH+COMMUNITY RESILIENCEBUILDING IN LIVELIHOOD & DISASTER RISK MANAGEMENT (REBUILD) IN TANJA-RIVER COUNTY



INTERNATIONAL COMMITTEE FOR DEVELOPMENT OF PEOPLE
 REGIONAL OFFICE AT
 MANVALESTRA OFFICE
 JAMES GICHURU LANSINGTON,
 NAIROBI, KENYA
 Email: kenya@cisp-dko.org

INDIVIDUALCONSULTANT

ENG. JMR
 P.O BOX 72398-0200
 NAIROBI, KENYA
 Telephone: +254 - 722617042 Email:
 rameso@yahoo.com

Layout & Profile

CHAINAGE: 2+000 TO 2+500

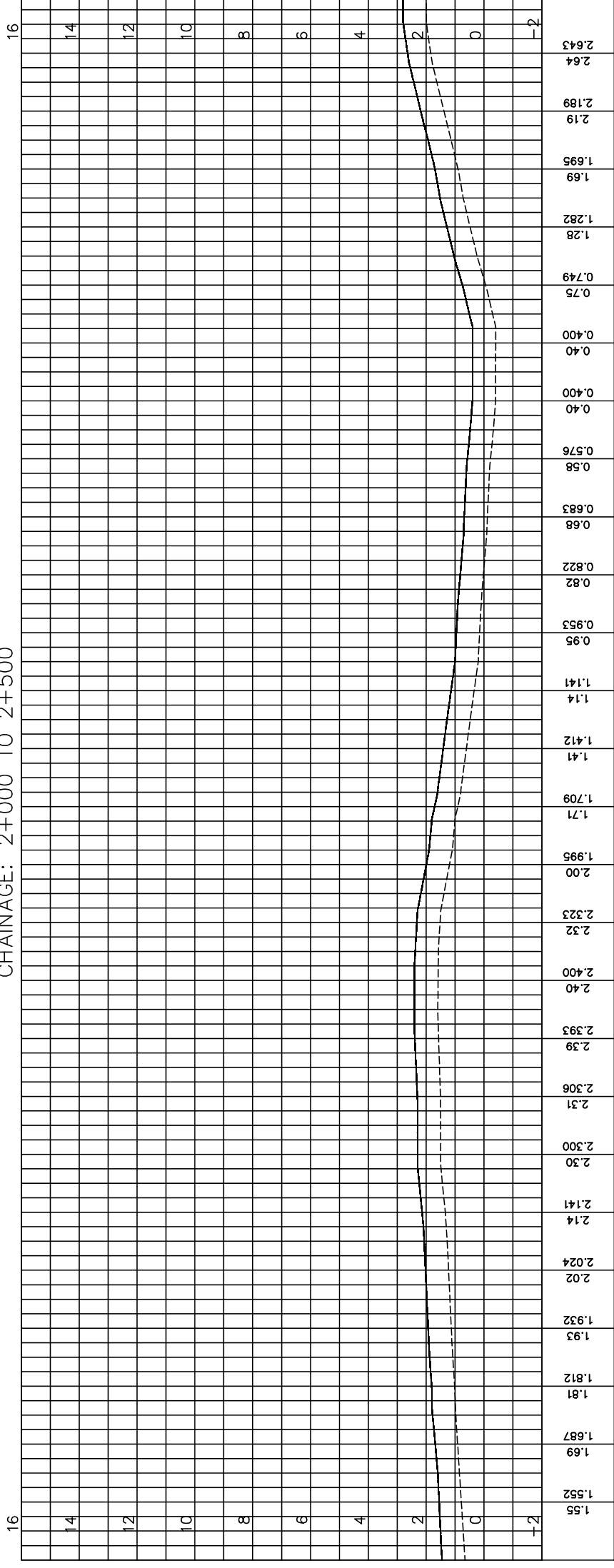

Pipe 55mm Dia, at 0.8m min. depth.

CHAINAGE: 2+500 TO 3+000

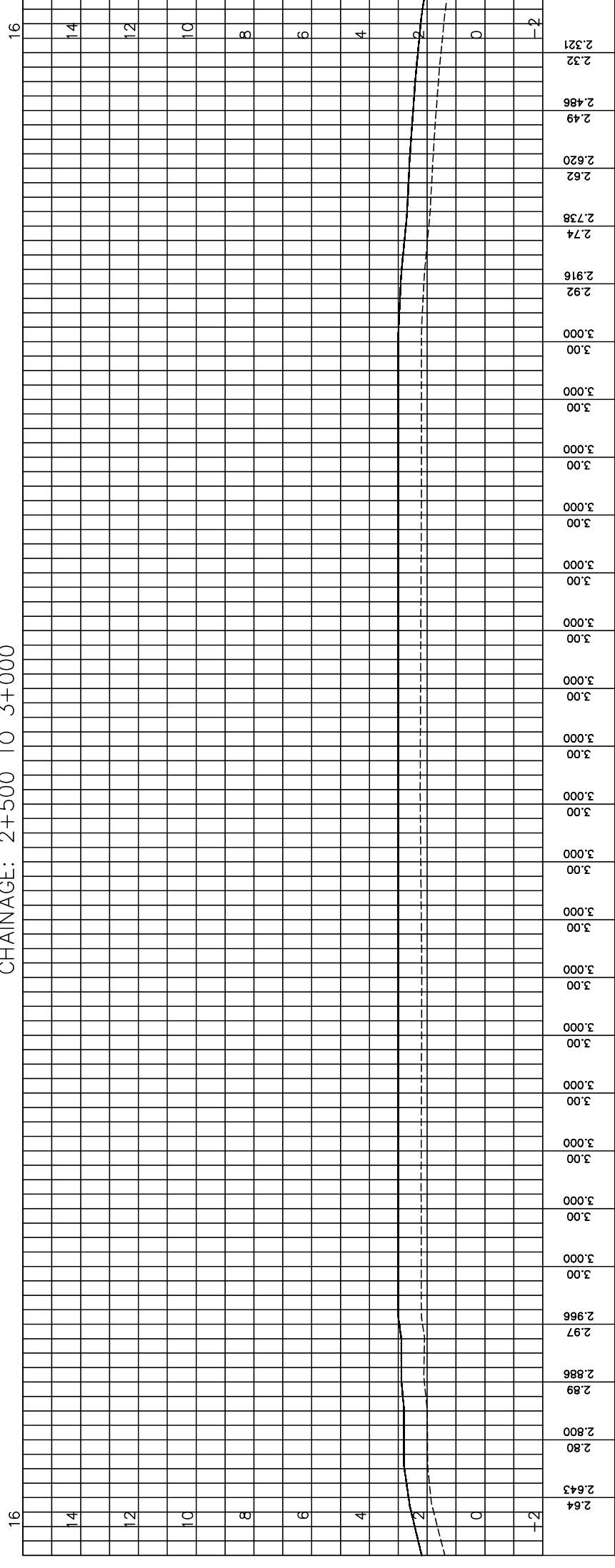

Pipe 55mm Dia, at 0.8m min. depth.

NOTES:

- All Levels are in metres based on National Datum
- All dimensions are in meters unless otherwise specified.

LEGEND:-



REV	REVISIONS	BY	DATE	APPROVED
4				
3				
2				
1				

PROJECT: WASH-COMMUNITY RESILIENCE BUILDING IN LIVELIHOOD & DISASTER RISK MANAGEMENT (REBUILD) IN TANU-RIVER COUNTY

CISP
CENTRAL INSTITUTE FOR
SUSTAINABLE INFRASTRUCTURE
PLANNING

INTERNATIONAL COMMITTEE
FOR DEVELOPMENT OF PEOPLE
NAIROBI OFFICE # 117
MANYANI EAST ROAD, OFF
JAMES GICHURU, LIVINGSTON,
NAIROBI, KENYA
Email: kenya@cisplanning.org

INDIVIDUAL CONSULTANT
ENG. JMR
P.O BOX 72398-0200
NAIROBI, KENYA
Telephone: +254 - 722617042 Email:
ramesso@yahoo.com

Layout & Profile

CHAINAGE: 3+000 TO 3+500

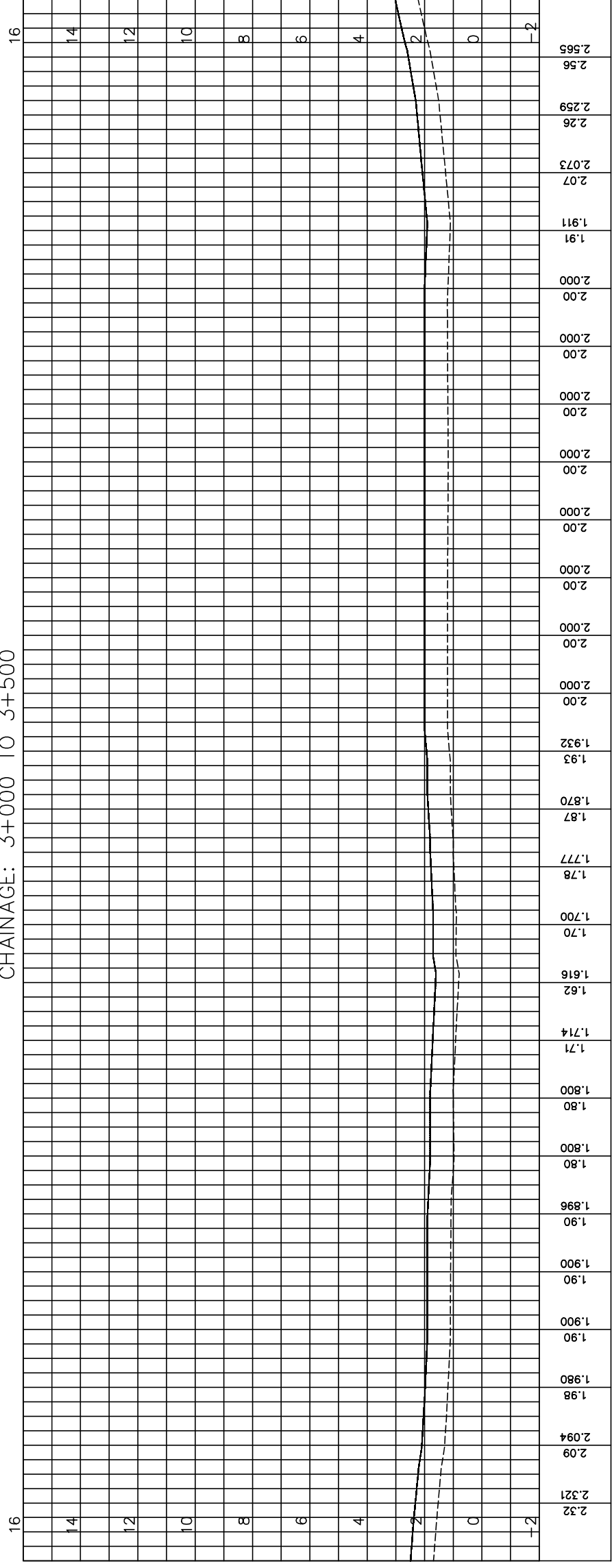

Pipe 55mm Dia, at 0.8m min. depth.

CHAINAGE: 3+500 TO 4+000

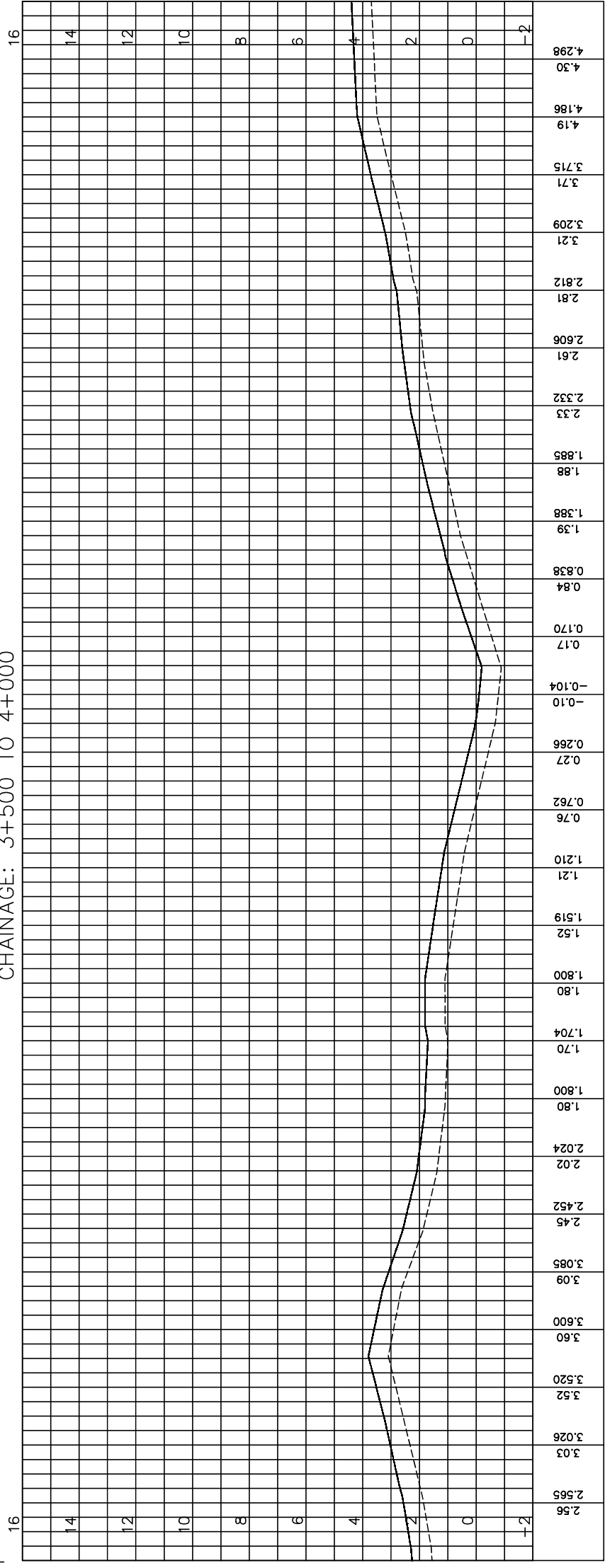

Pipe 55mm Dia, at 0.8m min. depth.

NOTES:

- All Levels are in metres based on National Datum
- All dimensions are in meters unless otherwise specified.

LEGEND:-



NORTH



SURVEY BENCHMARK

REV	REVISIONS	BY	DATE	APPROVED
4				
3				
2				
1				

PROJECT: WASH-COMMUNITY RESILIENCE BUILDING IN LIVELIHOOD & DISASTER RISK MANAGEMENT (REBUILD) IN TANU-RIVER COUNTY



INTERNATIONAL COMMITTEE FOR DEVELOPMENT OF PEOPLE
 NAIROBI OFFICE # 117
 MANYANI EAST ROAD, OFF JAMES GICHURU, LIVINGSTON, NAIROBI, KENYA
 Email: kenya@cisppartnership.org

INDIVIDUAL CONSULTANT
 ENG. JMR
 P.O BOX 72398-0200
 NAIROBI, KENYA

Telephone: +254 - 722617042 Email: ramesso@yahoo.com

Layout & Profile

Scale: 1:500

Date: JUNE 2022

DWG No Kelo Kelo

4/8

NOTES:

1. All Levels are in metres based on National Datum
2. All dimensions are in meters unless otherwise specified.

LEGEND: -



SURVEY BENCHMARK

CHAINAGE: 4+000 TO 4+500

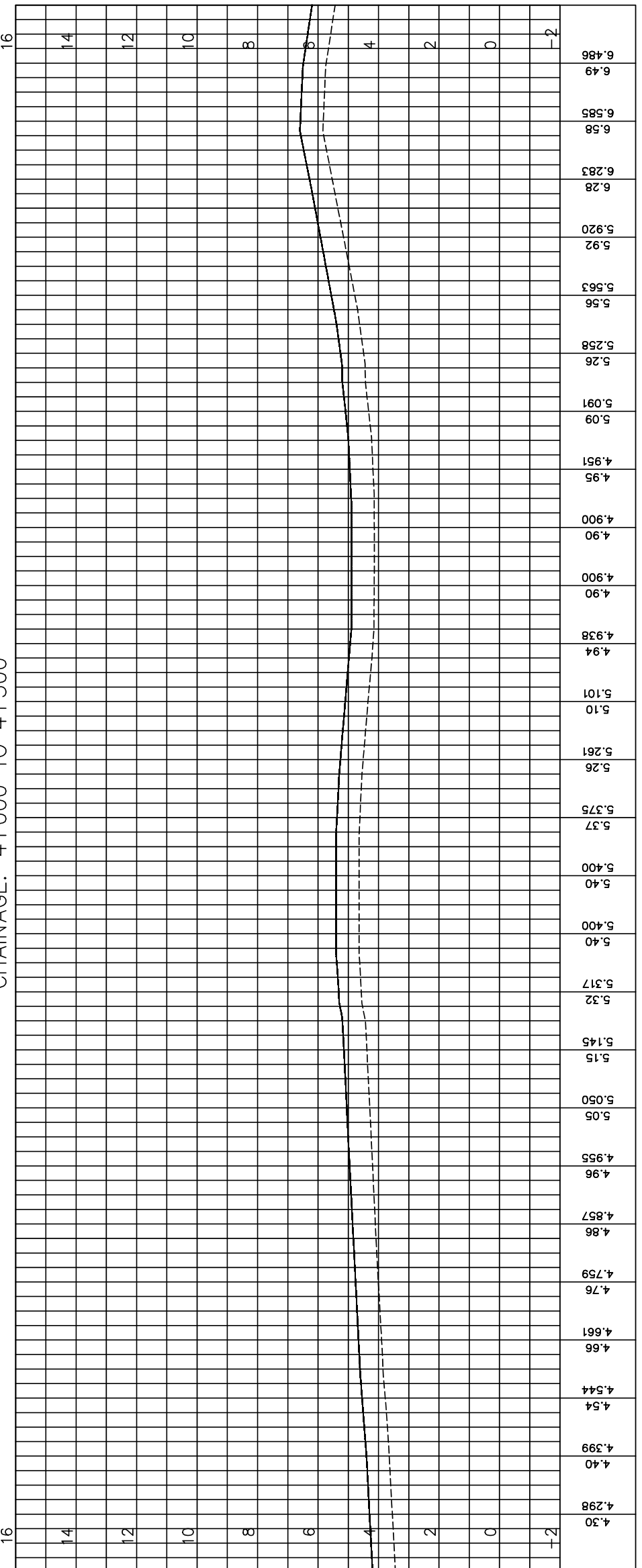

Pipe 55mm Dia, at 0.8m min. depth.

CHAINAGE: 4+500 TO 5+000

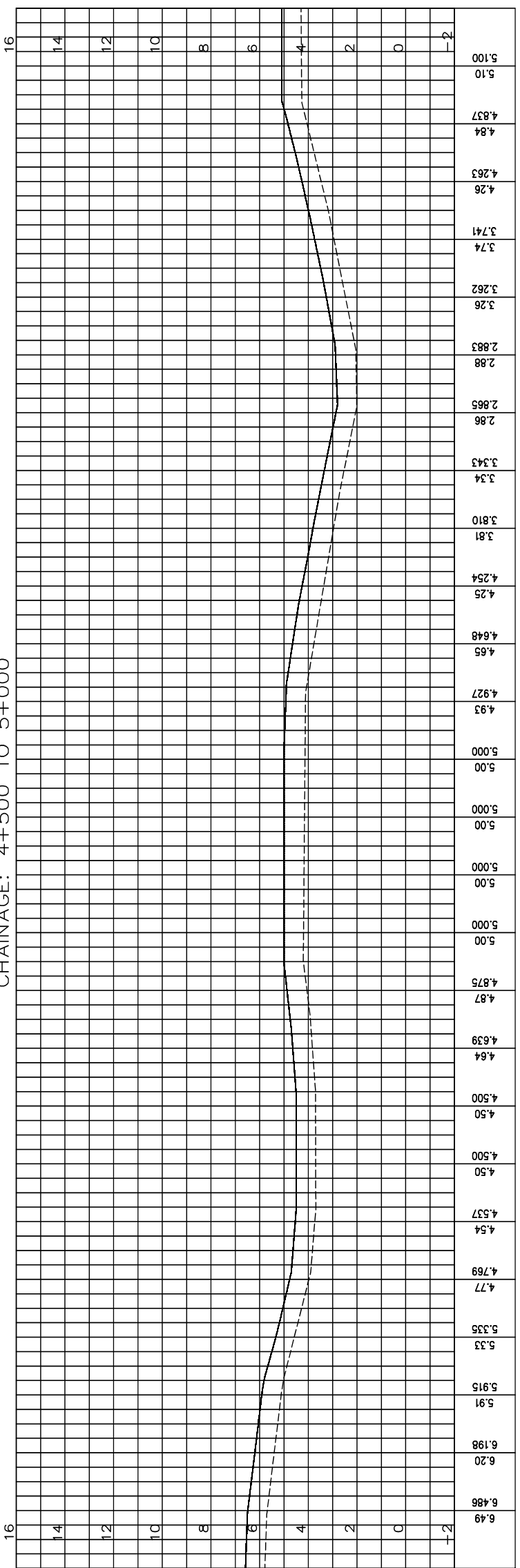

Pipe 55mm Dia, at 0.8m min. depth.

REV	REVISIONS	DATE	BY
4	ISSUED		
3	REVISED		
2	REVISED		
1	REVISED		

PROJECT: WASH-COMMUNITY RESILIENCE BUILDING IN LIVELIHOOD & DISASTER RISK MANAGEMENT (REBUILD) IN TANA-RIVER COUNTY



INTERNATIONAL COMMITTEE FOR DEVELOPMENT OF PEOPLE
 NAIROBI OFFICE # 117
 MANYANI EAST ROAD, OFF
 JAMES GICHURU, LAVINGTON,
 NAIROBI, KENYA
 Email: kenya@cisp-ngo.org

INDIVIDUAL CONSULTANT
 ENG. JMR
 P.O BOX 72398-0200
 NAIROBI, KENYA
 Telephone: +254 - 722617042 Email: ramesso@yahoo.com

Layout & Profile

CHAINAGE: 5+500 TO 6+000

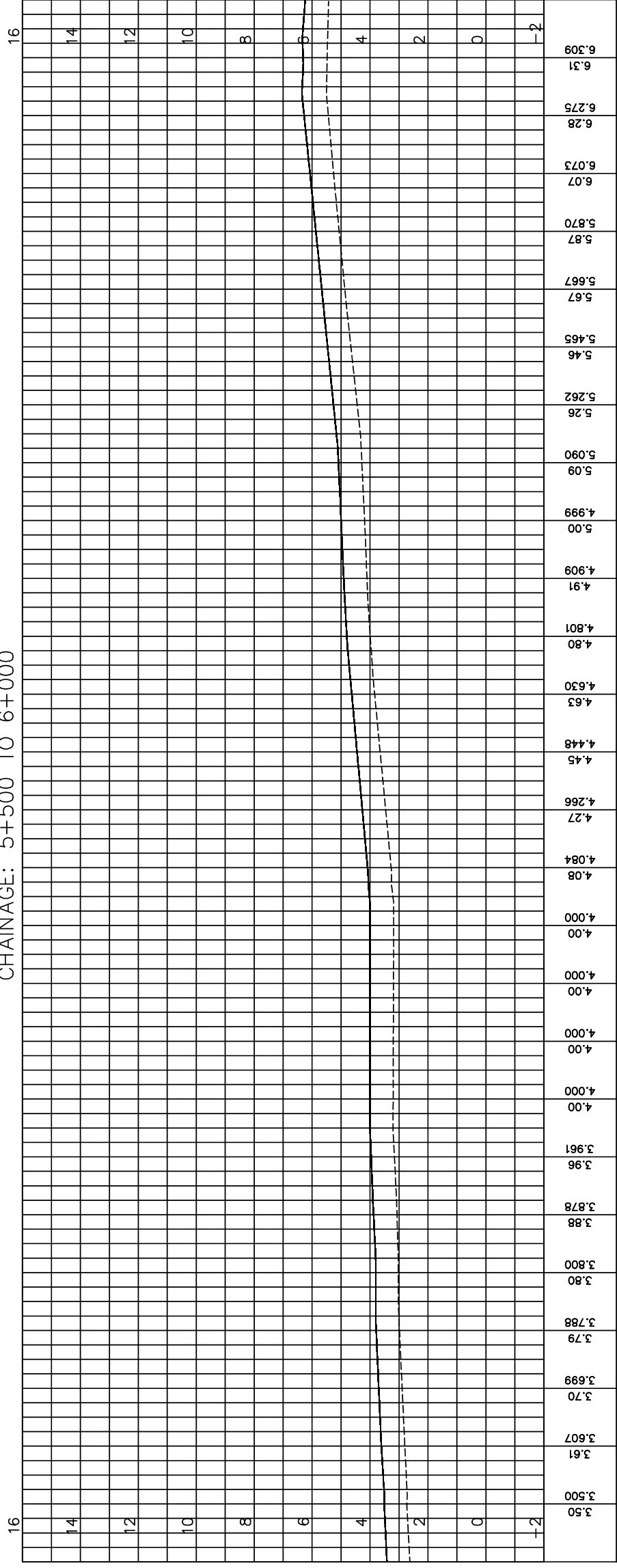

Pipe 55mm Dia, at 0.8m min. depth.

CHAINAGE: 5+000 TO 5+500

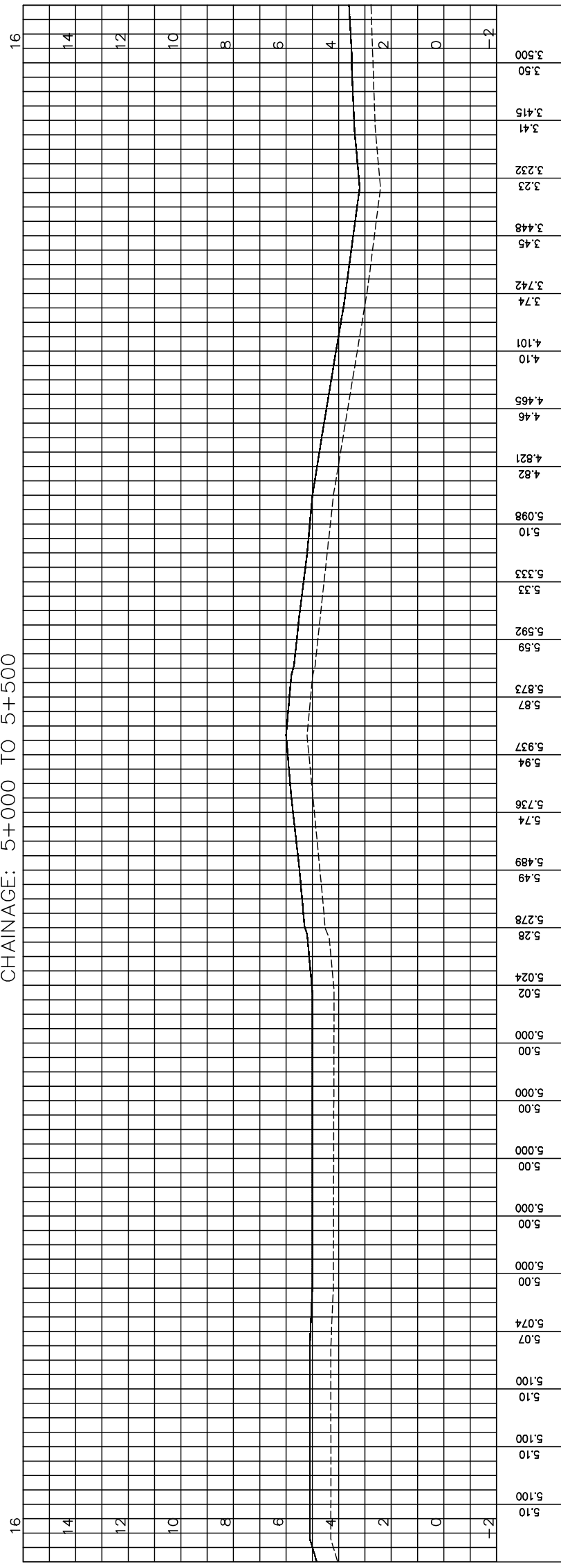

Pipe 55mm Dia, at 0.8m min. depth.

NOTES:

- All Levels are in metres based on National Datum.
- All dimensions are in meters unless otherwise specified.

LEGEND: -



SURVEY BENCHMARK



NO	REVISIONS	BY	DATE	APPROVED
4				
3				
2				
1				

PROJECT: WASH-COMMUNITY RESILIENCE BUILDING IN LIVELIHOOD & DISASTER RISK MANAGEMENT (REBUILD) IN TANU-RIVER COUNTY



INTERNATIONAL COMMITTEE FOR DEVELOPMENT OF PEOPLE
 NAIROBI OFFICE # 117
 MANYANI EAST ROAD, OFF
 JAMES GICHURU, LAVINGTON,
 NAIROBI, KENYA
 Email: kenya@cisp-ngo.org

INDIVIDUALCONSULTANT
 ENG. JMR
 P.O BOX 72398-0200
 NAIROBI, KENYA
 Telephone: +254 - 722617042 Email:
 ramesse@yahoo.com

Layout & Profile

Scale: 1:200 Date: JUNE 2022

DWG NO. Kelo Kelo

4/8

CHAINAGE: 6+000 TO 6+500

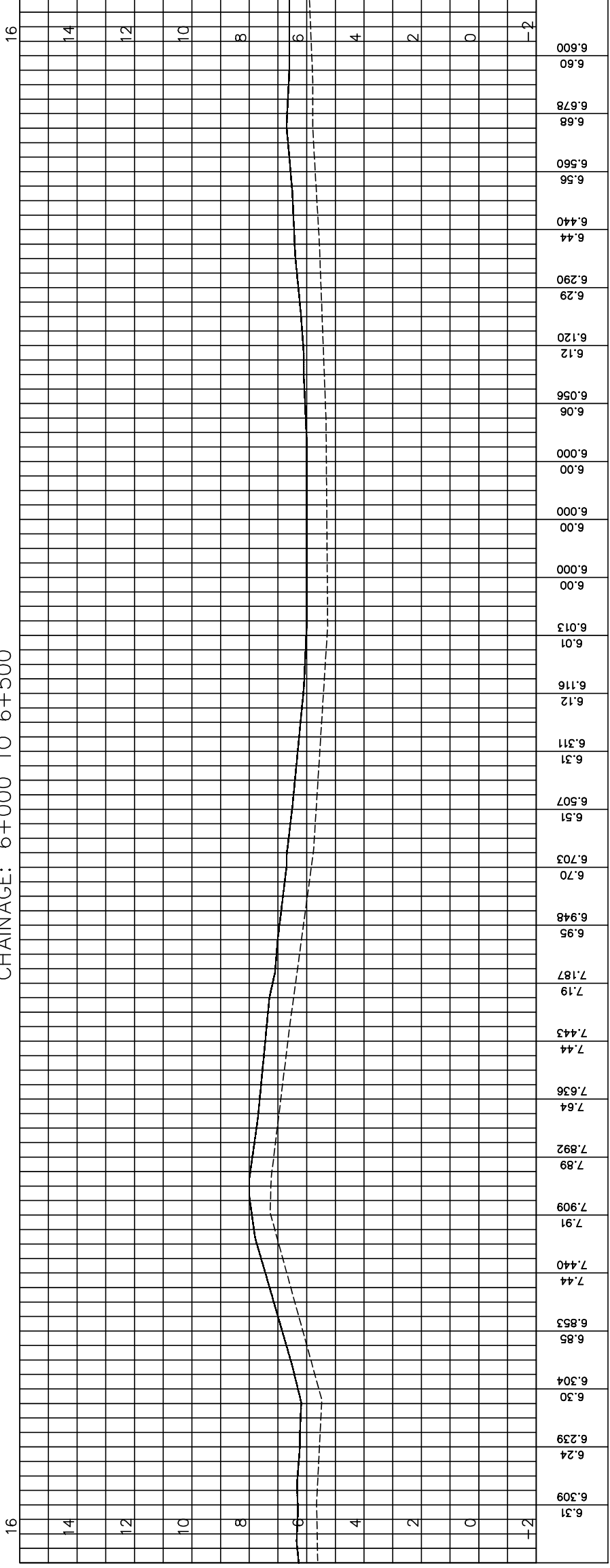

Pipe 55mm Dia, at 0.8m min. depth.

CHAINAGE: 6+500 TO 7+000

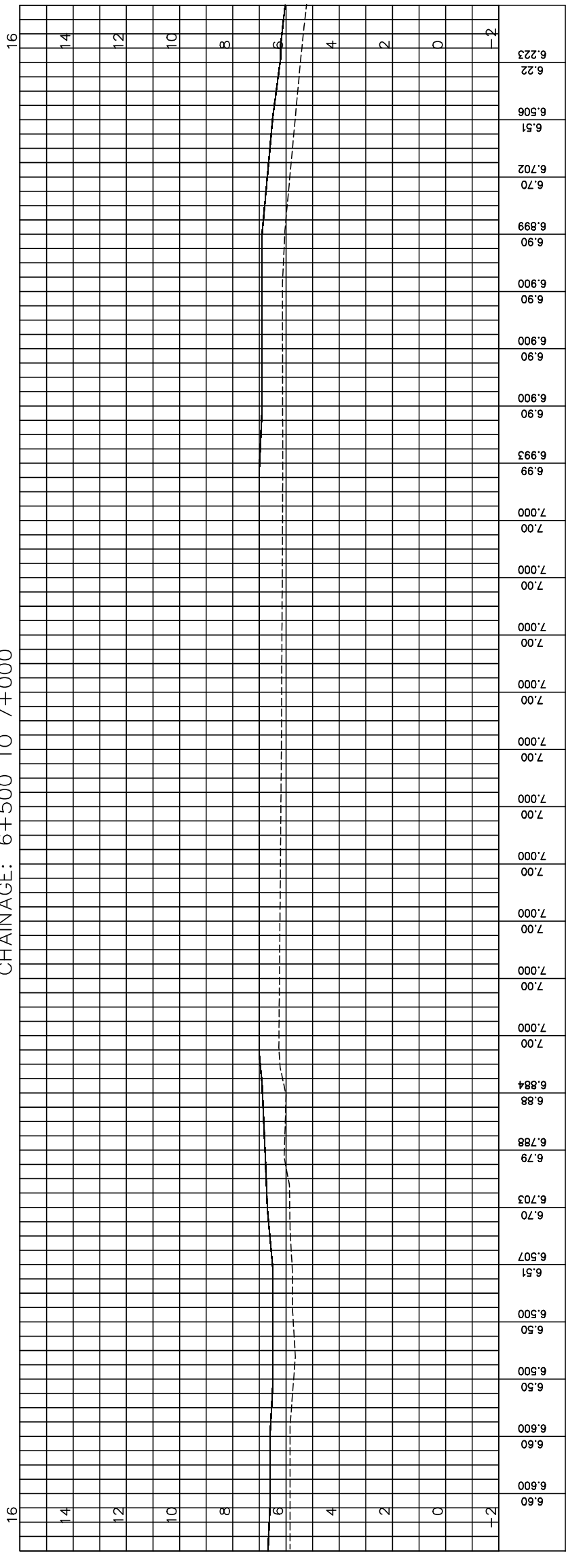

Pipe 55mm Dia, at 0.8m min. depth.

NOTES:

- All Levels are in metres based on National Datum.
- All dimensions are in meters unless otherwise specified.

LEGEND:--



NORTH



SURVEY BENCHMARK

REV	REVISIONS	DATE	APPROVED
1	IF		
2	IF		
3	IF		
4	IF		
5	IF		
6	IF		
7	IF		
8	IF		
9	IF		
10	IF		

PROJECT: WASH-COMMUNITY RESILIENCE BUILDING IN LIVELIHOOD & DISASTER RISK MANAGEMENT (REBUILD) IN TANARIVER COUNTY



INTERNATIONAL COMMITTEE FOR DEVELOPMENT OF PEOPLE
 NAIROBI OFFICE # 117
 MANYANI EAST ROAD, OFF JAMES GICHURU, LAVINGTON, NAIROBI, KENYA
 Email: kenya@cisp-ngo.org

INDIVIDUALCONSULTANT
 ENG. JMR
 P.O BOX 72398-0200
 Nairobi, KENYA
 Telephone: +254 - 722617042 Email: ramesso@yahoo.com

Layout & Profile

Scale: 1:200

Date: JUNE 2022

DWG NO: Kelo Kelo 4/8

CHAINAGE: 7+000 TO 7+500

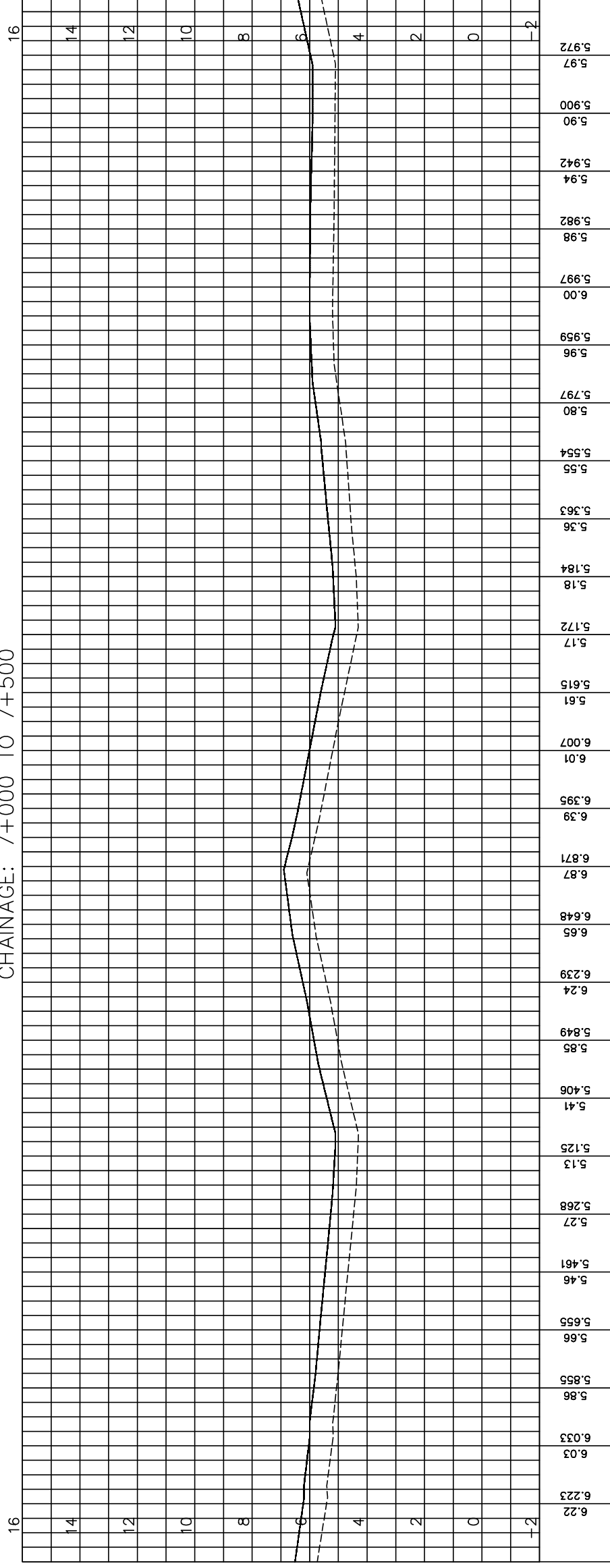

Pipe 55mm Dia, at 0.8m min. depth.

CHAINAGE: 7+500 TO 8+000

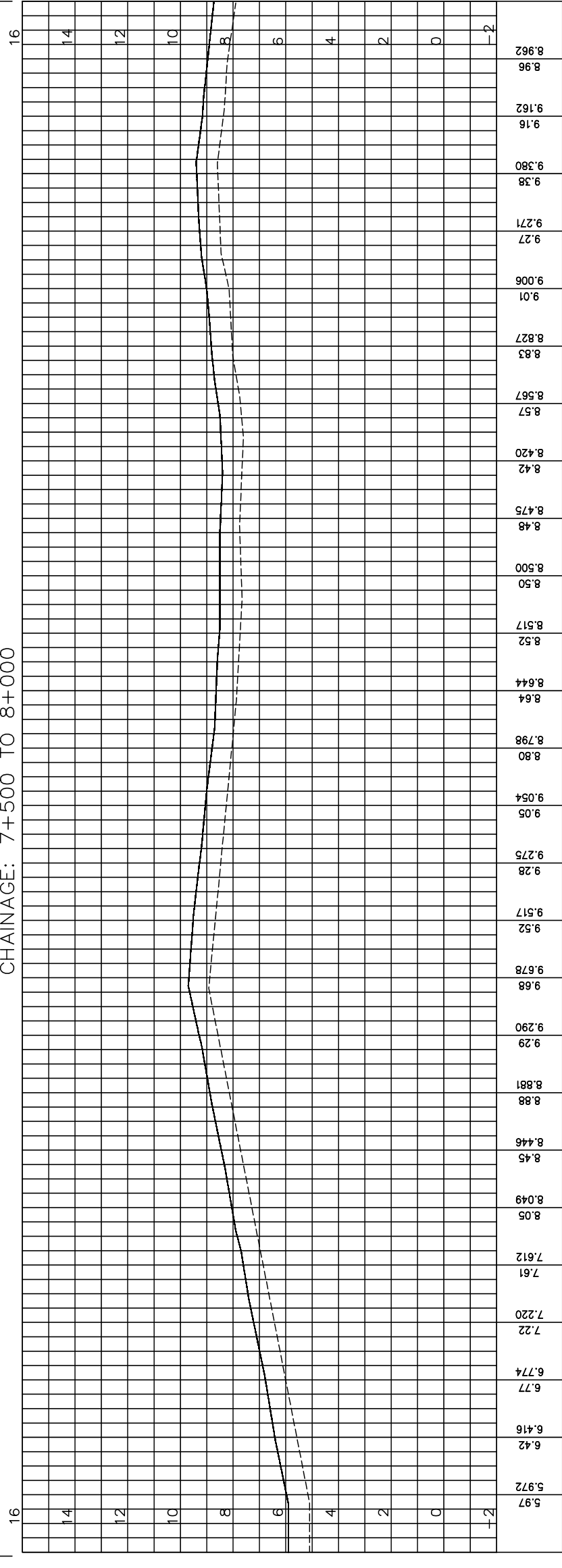

Pipe 55mm Dia, at 0.8m min. depth.

NOTES:

- All Levels are in metres based on National Datum
- All dimensions are in meters unless otherwise specified.

LEGEND:--



NO	REVISIONS	DATE	BY	CHKD	APPROVED
4					
3					
2					
1					

PROJECT: WASH-COMMUNITY RESILIENCE BUILDING IN LIVELIHOOD & DISASTER RISK MANAGEMENT (REBUILD) IN TANA-RIVER COUNTY



INTERNATIONAL COMMITTEE FOR DEVELOPMENT OF PEOPLE
 NAIROBI OFFICE # 117
 MANYANI EAST ROAD, OFF
 JAMES GICHURU, LAVINGTON,
 NAIROBI, KENYA
 Email: kenya@cisp-ipo.org

INDIVIDUAL CONSULTANT
 ENG. JMR
 P.O BOX 72398-0200
 NAIROBI, KENYA
 Telephone: +254 - 722617042 Email: raimesso@yahoo.com

Layout & Profile

CHAINAGE: 8+000 TO 8+500

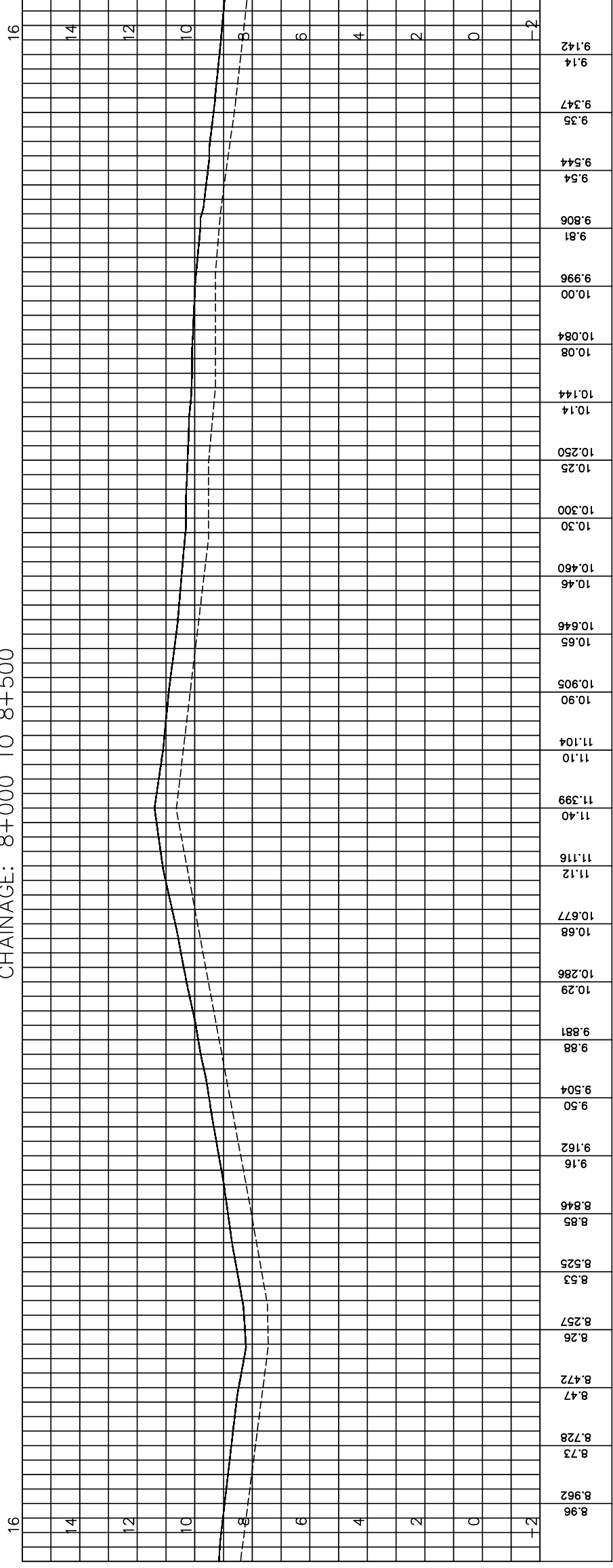

Pipe 55mm Dia, at 0.8m min. depth.

CHAINAGE: 8+500 TO 9+000

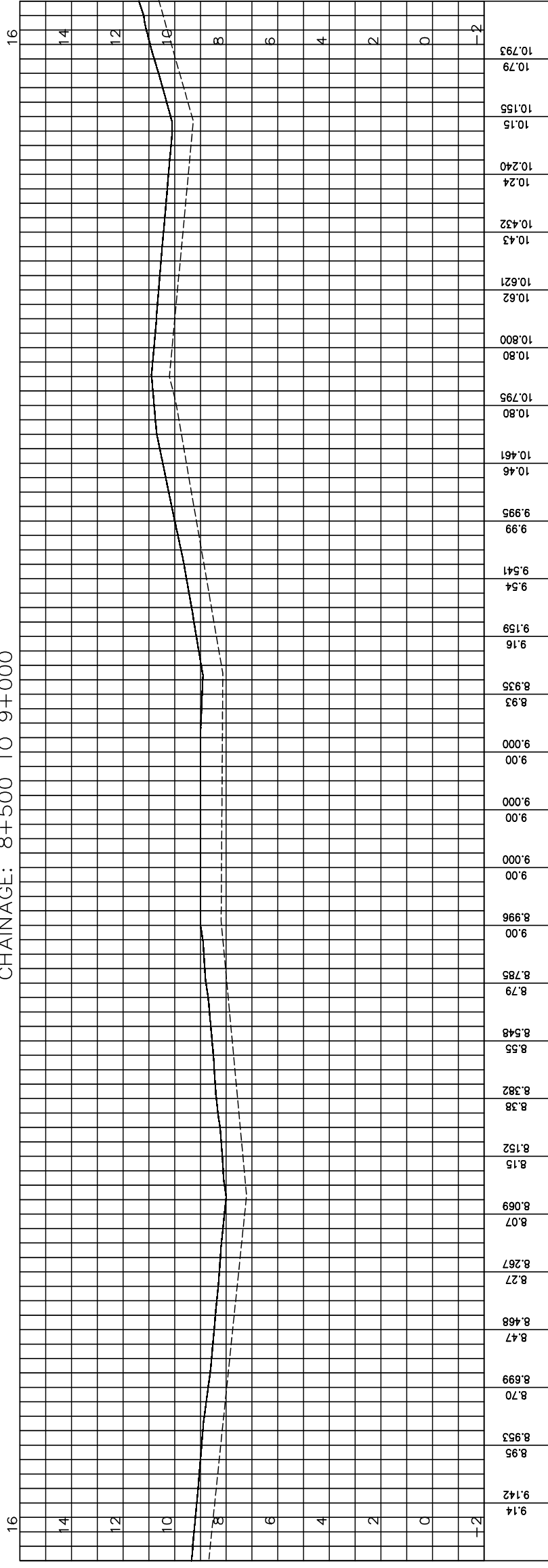

Pipe 55mm Dia, at 0.8m min. depth.

NOTES:

- All Levels are in metres based on National Datum
- All dimensions are in meters unless otherwise specified.

LEGEND:-



NORTH

SURVEY BENCHMARK

REV	REVISIONS	BY	DATE	APPROVED
4				
3				
2				
1				

PROJECT: WASH-COMMUNITY RESILIENCE BUILDING IN LIVELIHOOD & DISASTER RISK MANAGEMENT (REBUILD) IN TANARIVER COUNTY

CISP
 INTERNATIONAL COMMITTEE FOR DEVELOPMENT OF PEOPLE
 NAIROBI OFFICE # 117
 MANYANI EAST ROAD, OFF JAMES GICHURU, LIVINGSTON, NAIROBI, KENYA
 Email: kenya@cisp-ngo.org

INDIVIDUAL CONSULTANT
 ENG. JMR
 P.O BOX 72398-0200
 NAIROBI, KENYA
 Telephone: +254 - 722617042 Email: ramesso@yahoo.com

Layout & Profile

CHAINAGE: 9+000 TO 9+500

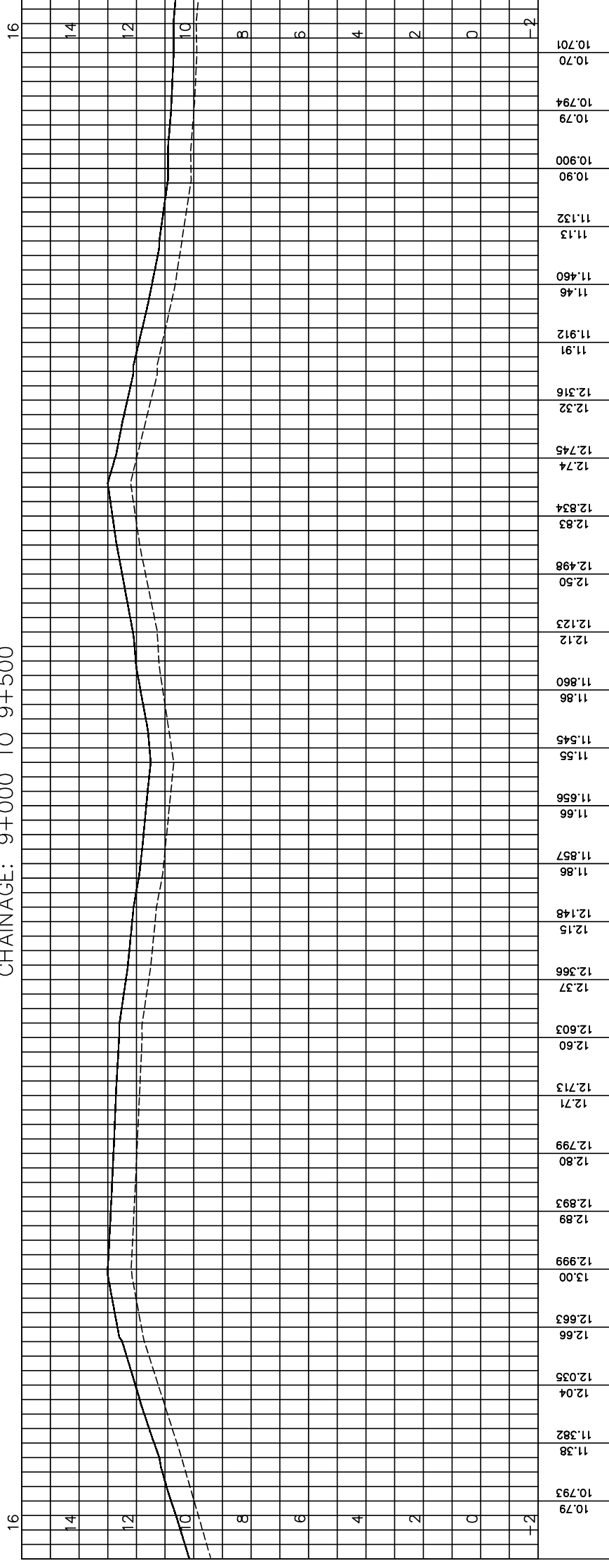

Pipe 55mm Dia, at 0.8m min. depth.

CHAINAGE: 9+500 TO 10+000

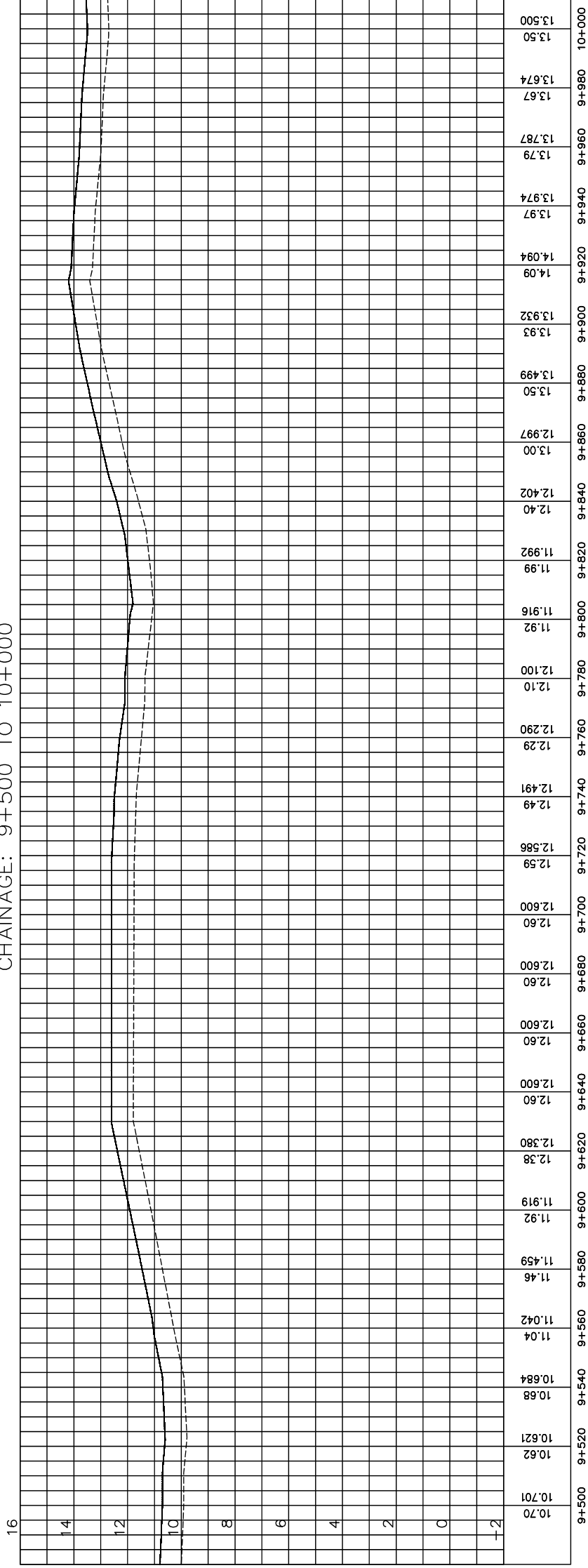

Pipe 55mm Dia, at 0.8m min. depth.

NOTES:

- All Levels are in metres based on National Datum
- All dimensions are in meters unless otherwise specified.

LEGEND: -



NORTH



SURVEY BENCHMARK

REV	REVISIONS	BY	DATE	APPROVED
4				
3				
2				
1				

PROJECT: WASH-COMMUNITY RESILIENCE BUILDING IN LIVELIHOOD & DISASTER RISK MANAGEMENT (REBUILD) IN TAN-RIVER COUNTY



INTERNATIONAL COMMITTEE FOR DEVELOPMENT OF PEOPLE
 NAIROBI OFFICE # 117
 MANYANI EAST ROAD, OFF CAMPUS UNIVERSITY, NAIROBI, KENYA
 Email: kenya@cisp-dk.org

INDIVIDUAL CONSULTANT
 ENG. JMR
 P.O BOX 72398-0200
 NAIROBI, KENYA
 Telephone: +254 - 722617042 Email: ramieso@yahoo.com

Layout & Profile

Scale: 1:500 Date: JUNE 2022

DWGS NO Kelo Kelo

4/8

CHAINAGE: 10+000 TO 10+500

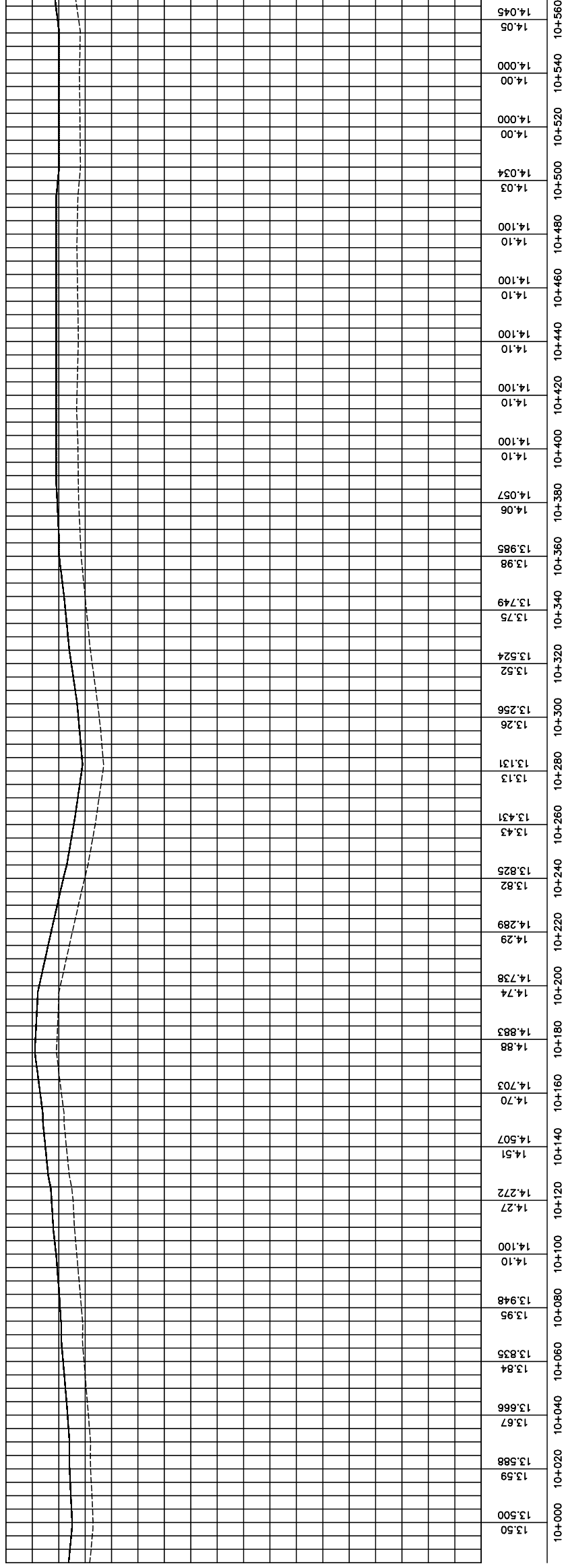

— Pipe 55mm Dia, at 0.8m min. depth.

CHAINAGE: 10+560 TO 10+780

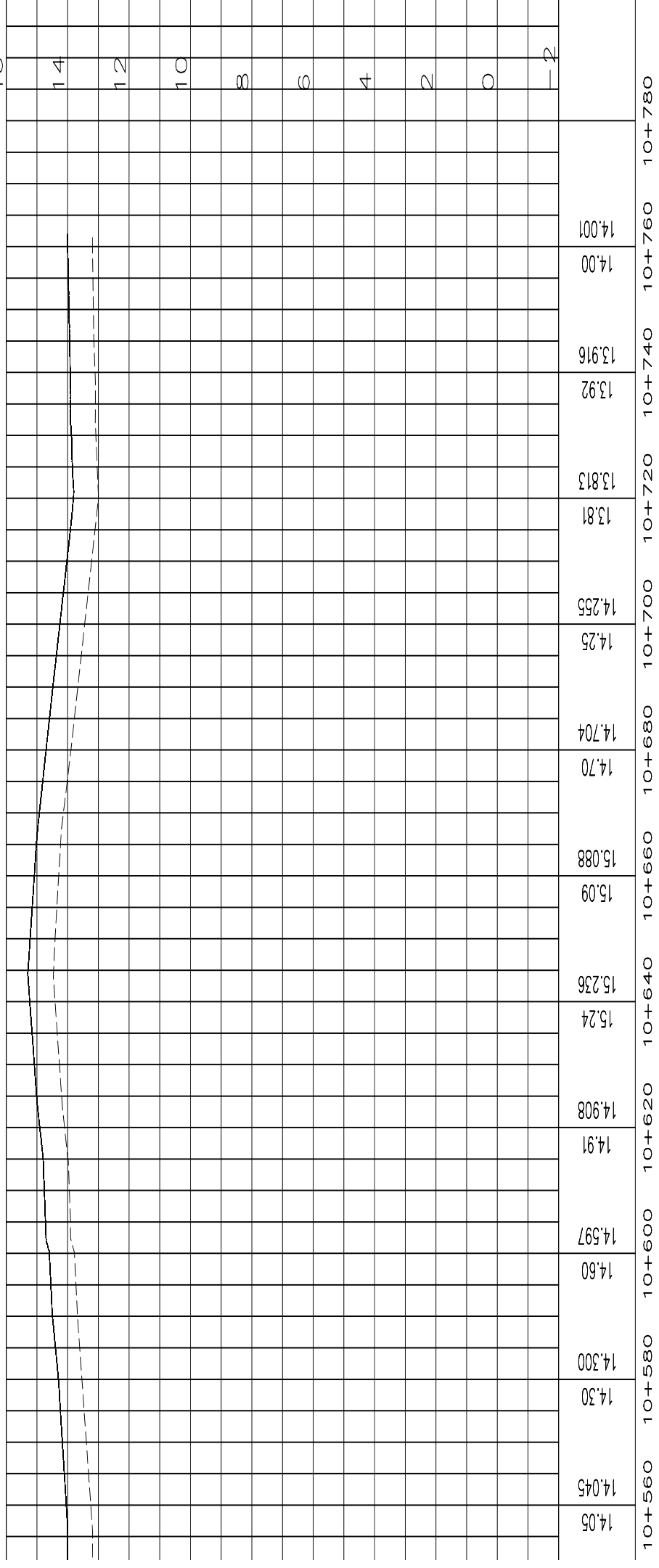

— Pipe 55mm Dia, at 0.8m min. depth.

NOTES:

- All Levels are in metres based on National Datum
- All dimensions are in meters unless otherwise specified.

LEGEND: -



NO	REVISIONS	DATE	APPROVED
4	REVISED		
3	REVISED		
2	REVISED		
1	REVISED		

PROJECT: WASH-COMMUNITY RESILIENCE BUILDING IN LIVELIHOOD & DISASTER RISK MANAGEMENT (REBUILD) IN TANU-RIVER COUNTY



INTERNATIONAL COMMITTEE FOR DEVELOPMENT OF PEOPLE
 NAIROBI OFFICE # 117
 MANYANI EAST ROAD, OFF
 JAMES GICHURU, LAVINGTON,
 NAIROBI, KENYA
 Email: kenya@cisp-ngo.org

INDIVIDUAL CONSULTANT
 ENG. JMR
 P.O BOX 72398-0200
 Nairobi, KENYA
 Telephone: +254 - 722617042 Email: ramesso@yahoo.com

Layout & Profile

NOTES

1. CONCRETE TO BE CEMENTY PORTLAND CEMENT TO B.S. 4139
2. CONCRETE AGGREGATE TO COMPLY WITH B.S. 684
3. WATER IN CONCRETE MIXES TO BE 20% MAX
4. CONCRETE FILL AND BRICKS IN CLASS 10/10
5. BRICKS TO BE FULL BODY AND TO COMPLY WITH B.S. 3703
6. BRICKS TO BE LAYED IN STRETCH COURSE TO BE 40mm
7. BRICKS TO BE LAYED IN STRETCH COURSE TO BE 40mm
8. BRICKS TO BE LAYED IN STRETCH COURSE TO BE 40mm
9. BRICKS TO BE LAYED IN STRETCH COURSE TO BE 40mm
10. BRICKS TO BE LAYED IN STRETCH COURSE TO BE 40mm
11. BRICKS TO BE LAYED IN STRETCH COURSE TO BE 40mm
12. BRICKS TO BE LAYED IN STRETCH COURSE TO BE 40mm
13. BRICKS TO BE LAYED IN STRETCH COURSE TO BE 40mm
14. BRICKS TO BE LAYED IN STRETCH COURSE TO BE 40mm
15. BRICKS TO BE LAYED IN STRETCH COURSE TO BE 40mm
16. BRICKS TO BE LAYED IN STRETCH COURSE TO BE 40mm
17. BRICKS TO BE LAYED IN STRETCH COURSE TO BE 40mm
18. BRICKS TO BE LAYED IN STRETCH COURSE TO BE 40mm
19. BRICKS TO BE LAYED IN STRETCH COURSE TO BE 40mm
20. BRICKS TO BE LAYED IN STRETCH COURSE TO BE 40mm
21. BRICKS TO BE LAYED IN STRETCH COURSE TO BE 40mm
22. BRICKS TO BE LAYED IN STRETCH COURSE TO BE 40mm
23. BRICKS TO BE LAYED IN STRETCH COURSE TO BE 40mm
24. BRICKS TO BE LAYED IN STRETCH COURSE TO BE 40mm
25. BRICKS TO BE LAYED IN STRETCH COURSE TO BE 40mm
26. BRICKS TO BE LAYED IN STRETCH COURSE TO BE 40mm
27. BRICKS TO BE LAYED IN STRETCH COURSE TO BE 40mm
28. BRICKS TO BE LAYED IN STRETCH COURSE TO BE 40mm
29. BRICKS TO BE LAYED IN STRETCH COURSE TO BE 40mm
30. BRICKS TO BE LAYED IN STRETCH COURSE TO BE 40mm
31. BRICKS TO BE LAYED IN STRETCH COURSE TO BE 40mm
32. BRICKS TO BE LAYED IN STRETCH COURSE TO BE 40mm
33. BRICKS TO BE LAYED IN STRETCH COURSE TO BE 40mm
34. BRICKS TO BE LAYED IN STRETCH COURSE TO BE 40mm
35. BRICKS TO BE LAYED IN STRETCH COURSE TO BE 40mm
36. BRICKS TO BE LAYED IN STRETCH COURSE TO BE 40mm
37. BRICKS TO BE LAYED IN STRETCH COURSE TO BE 40mm
38. BRICKS TO BE LAYED IN STRETCH COURSE TO BE 40mm
39. BRICKS TO BE LAYED IN STRETCH COURSE TO BE 40mm
40. BRICKS TO BE LAYED IN STRETCH COURSE TO BE 40mm
41. BRICKS TO BE LAYED IN STRETCH COURSE TO BE 40mm
42. BRICKS TO BE LAYED IN STRETCH COURSE TO BE 40mm
43. BRICKS TO BE LAYED IN STRETCH COURSE TO BE 40mm
44. BRICKS TO BE LAYED IN STRETCH COURSE TO BE 40mm
45. BRICKS TO BE LAYED IN STRETCH COURSE TO BE 40mm
46. BRICKS TO BE LAYED IN STRETCH COURSE TO BE 40mm
47. BRICKS TO BE LAYED IN STRETCH COURSE TO BE 40mm
48. BRICKS TO BE LAYED IN STRETCH COURSE TO BE 40mm
49. BRICKS TO BE LAYED IN STRETCH COURSE TO BE 40mm
50. BRICKS TO BE LAYED IN STRETCH COURSE TO BE 40mm
51. BRICKS TO BE LAYED IN STRETCH COURSE TO BE 40mm
52. BRICKS TO BE LAYED IN STRETCH COURSE TO BE 40mm
53. BRICKS TO BE LAYED IN STRETCH COURSE TO BE 40mm
54. BRICKS TO BE LAYED IN STRETCH COURSE TO BE 40mm
55. BRICKS TO BE LAYED IN STRETCH COURSE TO BE 40mm
56. BRICKS TO BE LAYED IN STRETCH COURSE TO BE 40mm
57. BRICKS TO BE LAYED IN STRETCH COURSE TO BE 40mm
58. BRICKS TO BE LAYED IN STRETCH COURSE TO BE 40mm
59. BRICKS TO BE LAYED IN STRETCH COURSE TO BE 40mm
60. BRICKS TO BE LAYED IN STRETCH COURSE TO BE 40mm
61. BRICKS TO BE LAYED IN STRETCH COURSE TO BE 40mm
62. BRICKS TO BE LAYED IN STRETCH COURSE TO BE 40mm
63. BRICKS TO BE LAYED IN STRETCH COURSE TO BE 40mm
64. BRICKS TO BE LAYED IN STRETCH COURSE TO BE 40mm
65. BRICKS TO BE LAYED IN STRETCH COURSE TO BE 40mm
66. BRICKS TO BE LAYED IN STRETCH COURSE TO BE 40mm
67. BRICKS TO BE LAYED IN STRETCH COURSE TO BE 40mm
68. BRICKS TO BE LAYED IN STRETCH COURSE TO BE 40mm
69. BRICKS TO BE LAYED IN STRETCH COURSE TO BE 40mm
70. BRICKS TO BE LAYED IN STRETCH COURSE TO BE 40mm
71. BRICKS TO BE LAYED IN STRETCH COURSE TO BE 40mm
72. BRICKS TO BE LAYED IN STRETCH COURSE TO BE 40mm
73. BRICKS TO BE LAYED IN STRETCH COURSE TO BE 40mm
74. BRICKS TO BE LAYED IN STRETCH COURSE TO BE 40mm
75. BRICKS TO BE LAYED IN STRETCH COURSE TO BE 40mm
76. BRICKS TO BE LAYED IN STRETCH COURSE TO BE 40mm
77. BRICKS TO BE LAYED IN STRETCH COURSE TO BE 40mm
78. BRICKS TO BE LAYED IN STRETCH COURSE TO BE 40mm
79. BRICKS TO BE LAYED IN STRETCH COURSE TO BE 40mm
80. BRICKS TO BE LAYED IN STRETCH COURSE TO BE 40mm
81. BRICKS TO BE LAYED IN STRETCH COURSE TO BE 40mm
82. BRICKS TO BE LAYED IN STRETCH COURSE TO BE 40mm
83. BRICKS TO BE LAYED IN STRETCH COURSE TO BE 40mm
84. BRICKS TO BE LAYED IN STRETCH COURSE TO BE 40mm
85. BRICKS TO BE LAYED IN STRETCH COURSE TO BE 40mm
86. BRICKS TO BE LAYED IN STRETCH COURSE TO BE 40mm
87. BRICKS TO BE LAYED IN STRETCH COURSE TO BE 40mm
88. BRICKS TO BE LAYED IN STRETCH COURSE TO BE 40mm
89. BRICKS TO BE LAYED IN STRETCH COURSE TO BE 40mm
90. BRICKS TO BE LAYED IN STRETCH COURSE TO BE 40mm
91. BRICKS TO BE LAYED IN STRETCH COURSE TO BE 40mm
92. BRICKS TO BE LAYED IN STRETCH COURSE TO BE 40mm
93. BRICKS TO BE LAYED IN STRETCH COURSE TO BE 40mm
94. BRICKS TO BE LAYED IN STRETCH COURSE TO BE 40mm
95. BRICKS TO BE LAYED IN STRETCH COURSE TO BE 40mm
96. BRICKS TO BE LAYED IN STRETCH COURSE TO BE 40mm
97. BRICKS TO BE LAYED IN STRETCH COURSE TO BE 40mm
98. BRICKS TO BE LAYED IN STRETCH COURSE TO BE 40mm
99. BRICKS TO BE LAYED IN STRETCH COURSE TO BE 40mm
100. BRICKS TO BE LAYED IN STRETCH COURSE TO BE 40mm

ABBREVIATIONS

- G.C.I. = GRAVEL
- D.C.I. = GRANULATED CORRUPTED IRON
- C.M. = CEMENT
- P.C. = PORTLAND CEMENT
- M.S. = MILD STEEL
- S.S. = STAINLESS STEEL
- R.C. = REINFORCED CONCRETE
- F.F. = FINISH FLOOR
- P.F. = PRECAST CONCRETE
- C.P. = CAST-IN-PLACE CONCRETE
- C.S. = CAST-IN-PLACE CONCRETE
- C.W. = CAST-IN-PLACE CONCRETE
- D.V. = DATE VALUE

PROJECT: WASH-COMMUNITY RESILIENCE BUILDING IN LIVELIHOOD & DISASTER RISK MANAGEMENT (REBUILD) IN TANA-RIVER COUNTY



INTERNATIONAL COMMITTEE FOR DEVELOPMENT OF PEOPLE
 NAIROBI OFFICE # 117
 MANYANI EAST ROAD, OFF JAMES GICHURU, LAVINGTON, NAIROBI, KENYA
 Email: kerrya@cicip-rngo.org

INDIVIDUALCONSULTANT
 ENG. JMR
 P.O BOX 72398-0200
 NAIROBI, KENYA
 Telephone: +254 - 722617042
 Email: ramesso@yahoo.com

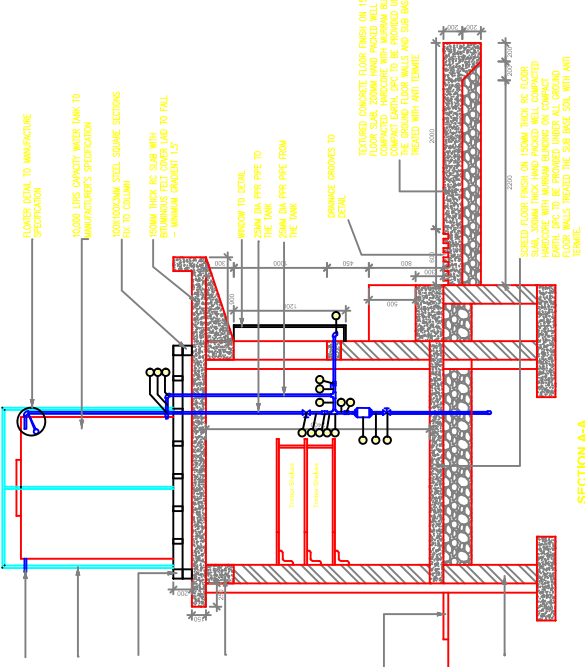
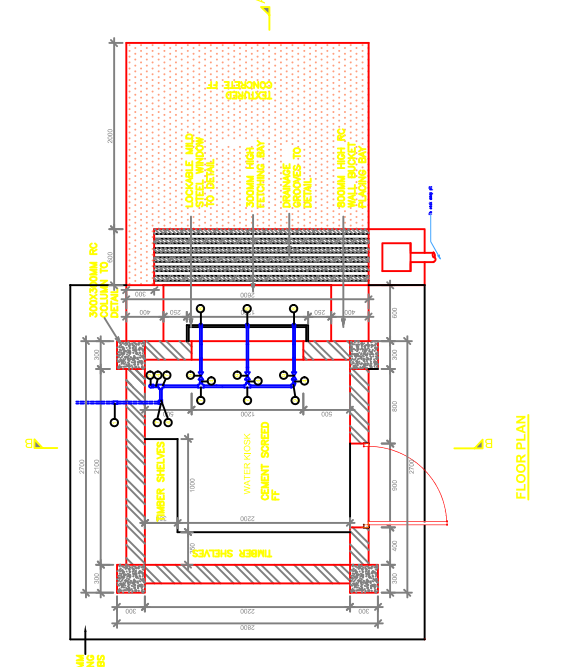
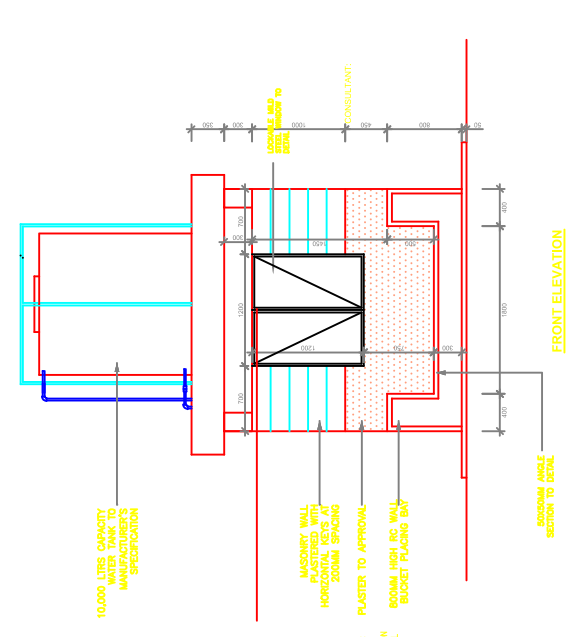
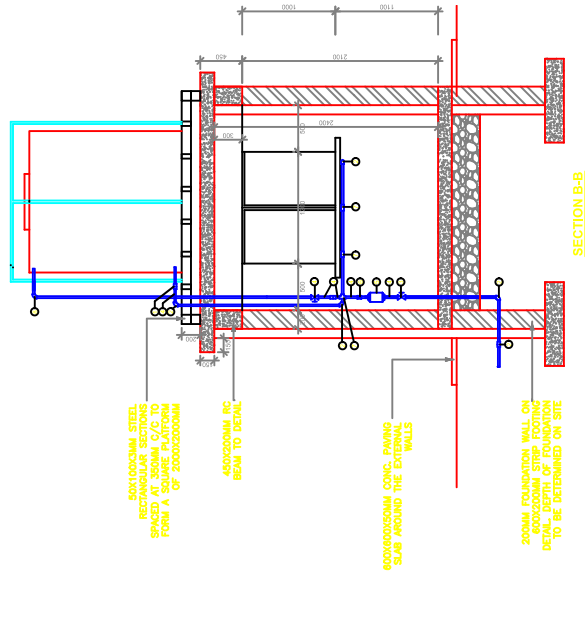

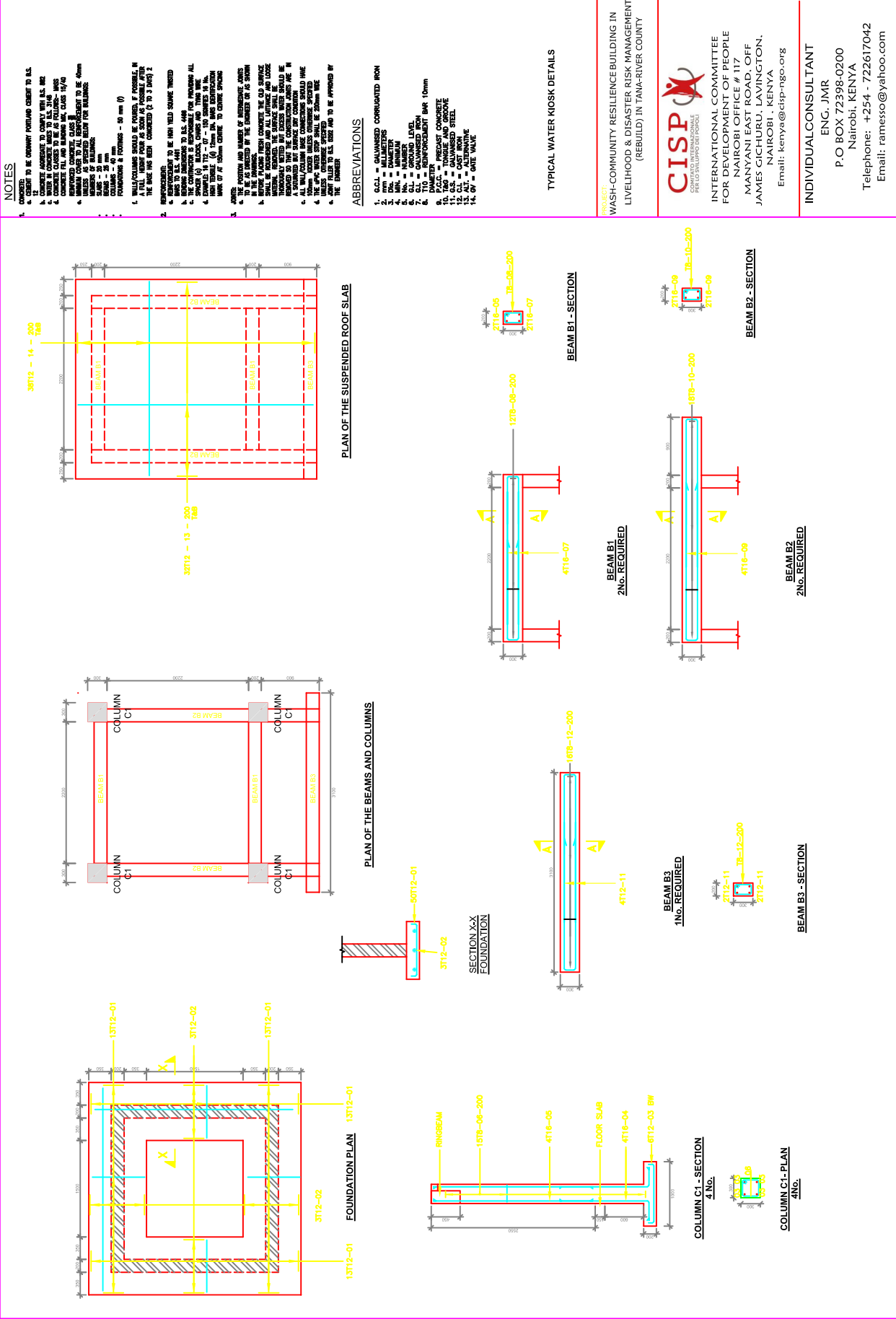

NOTES

1. CONCRETE TO BE COMPLY FORMULAE GIBBY TO S.L.
2. ALL WALLS TO BE CONCRETE TO S.L.
3. ALL WALLS TO BE CONCRETE TO S.L.
4. CONCRETE TO BE COMPLY FORMULAE GIBBY TO S.L.
5. ALL WALLS TO BE CONCRETE TO S.L.
6. ALL WALLS TO BE CONCRETE TO S.L.
7. ALL WALLS TO BE CONCRETE TO S.L.
8. ALL WALLS TO BE CONCRETE TO S.L.
9. ALL WALLS TO BE CONCRETE TO S.L.
10. ALL WALLS TO BE CONCRETE TO S.L.
11. ALL WALLS TO BE CONCRETE TO S.L.
12. ALL WALLS TO BE CONCRETE TO S.L.
13. ALL WALLS TO BE CONCRETE TO S.L.
14. ALL WALLS TO BE CONCRETE TO S.L.

ABBREVIATIONS

1. G.C.C. = GALVANISED CORRUGATED IRON
2. S.C.C. = SAND CONCRETE
3. S.L. = FINISHED FLOOR LEVEL
4. M.S. = MILD STEEL
5. R.C.C. = REINFORCED CONCRETE
6. R.C.C. = REINFORCED CONCRETE
7. R.C.C. = REINFORCED CONCRETE
8. R.C.C. = REINFORCED CONCRETE
9. R.C.C. = REINFORCED CONCRETE
10. R.C.C. = REINFORCED CONCRETE
11. R.C.C. = REINFORCED CONCRETE
12. R.C.C. = REINFORCED CONCRETE
13. R.C.C. = REINFORCED CONCRETE
14. R.C.C. = REINFORCED CONCRETE

TYPICAL WATER KIOSK DETAILS

PROJECT:
WASH-COMMUNITY RESILIENCE BUILDING IN LIVELIHOOD & DISASTER RISK MANAGEMENT (REBUILD) IN TANA-RIVER COUNTY

CISP
KENYA INVESTMENT PROMOTION BOARD
INTERNATIONAL COMMITTEE FOR DEVELOPMENT OF PEOPLE
NAIROBI OFFICE # 117
MANYANI EAST ROAD, OFF JAMES GICHURU, LAVINGTON, NAIROBI, KENYA
Email: kenya@cisp-ngo.org

INDIVIDUAL CONSULTANT
ENG. JMR
P.O BOX 72398-0200
Nairobi, KENYA
Telephone: +254 - 722617042
Email: ramesso@yahoo.com

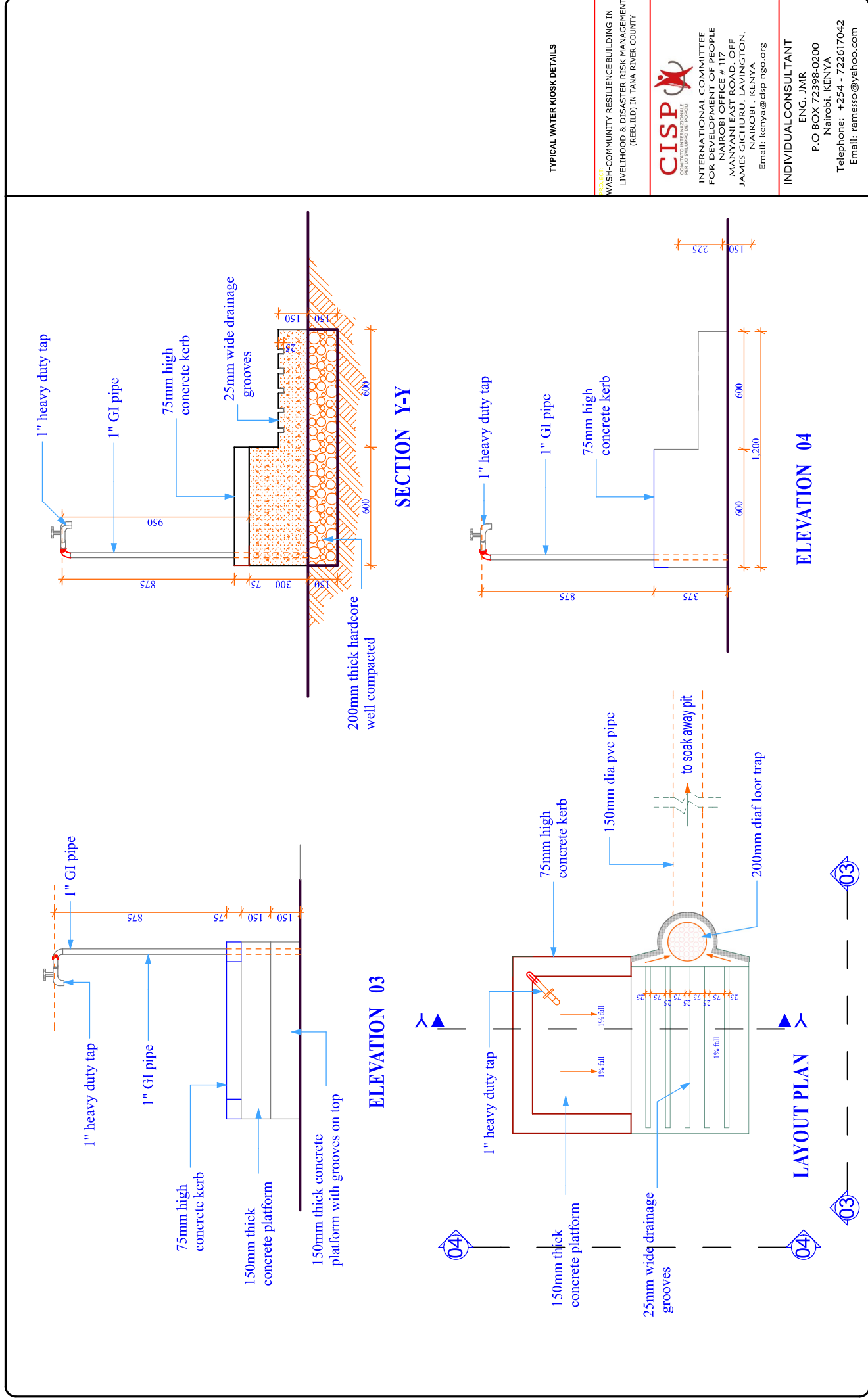

TYPICAL WATER KIOSK DETAILS

PROJECT:
WASH-COMMUNITY RESILIENCE BUILDING IN LIVELIHOOD & DISASTER RISK MANAGEMENT (REBUILD) IN TANA-RIVER COUNTY



CISP
CENTRE FOR INTEGRATED SOLUTIONS FOR THE DEVELOPMENT OF PEOPLE
INTERNATIONAL COMMITTEE FOR DEVELOPMENT OF PEOPLE
NAIROBI OFFICE # 117
MANYANI EAST ROAD, OFF JAMES GICHURU, LAVINGTON, NAIROBI - KENYA
Email: kenya@cisp-ngo.org

INDIVIDUAL CONSULTANT
ENC. JMR
P.O BOX 72398-0200
NAIROBI, KENYA
Telephone: +254 - 722617042
Email: ramesso@yahoo.com

Project Title: WATER KIOSK (open)	Client:		dra title: Yard tap	designed by	Checked By:	Consultant:	Scale:
--	----------------	--	-------------------------------	--------------------	--------------------	--------------------	---------------

**SOLAR PANEL STEEL STRUCTURE MOUNTED 3M FROM THE
GROUND**

200W - 24VDC

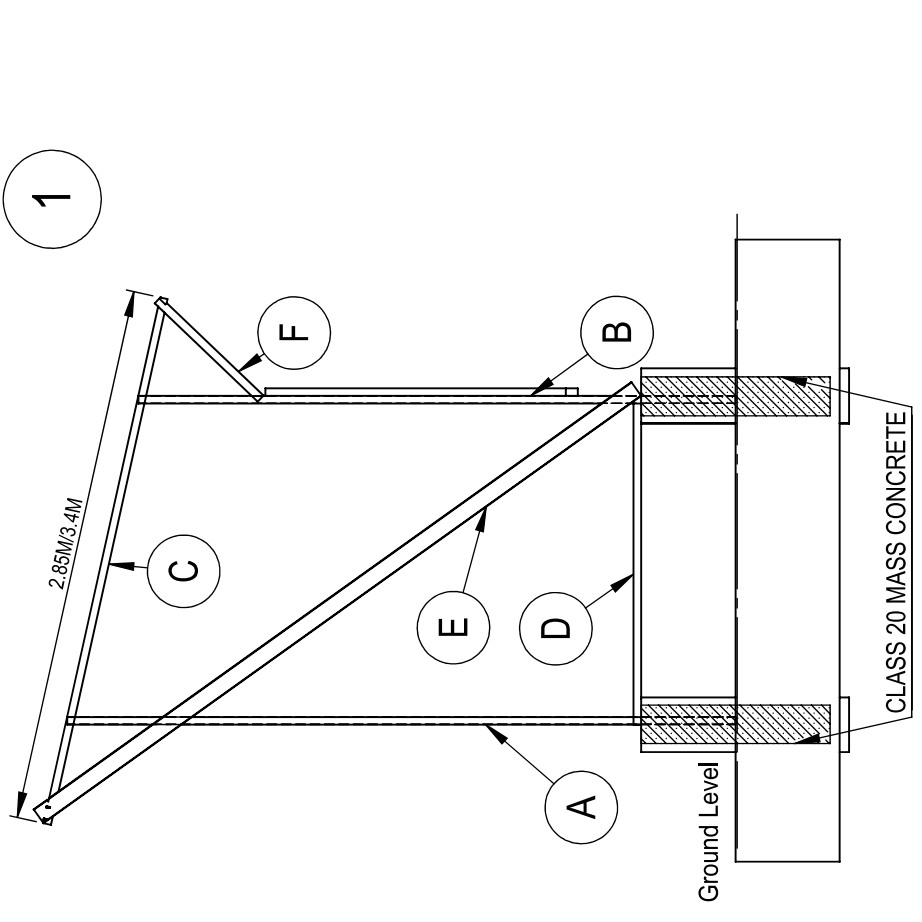

ITEM	SPECIFICATION	SECTION
1	SECTION SIDE PROFILE	
	A LEG A	PLAIN MEMBER
	B LEG B	PLAIN MEMBER
	C MAIN BEARER	PLAIN MEMBER
	D BOTTOM STRUT	PLAIN MEMBER
	E BRACING	PLAIN MEMBER
2	BATTENS	BATTEN
3	DIAGONAL BRACING	BATTEN
4	PVC FOOTING SLEEVES	200MM PVC CLASS B

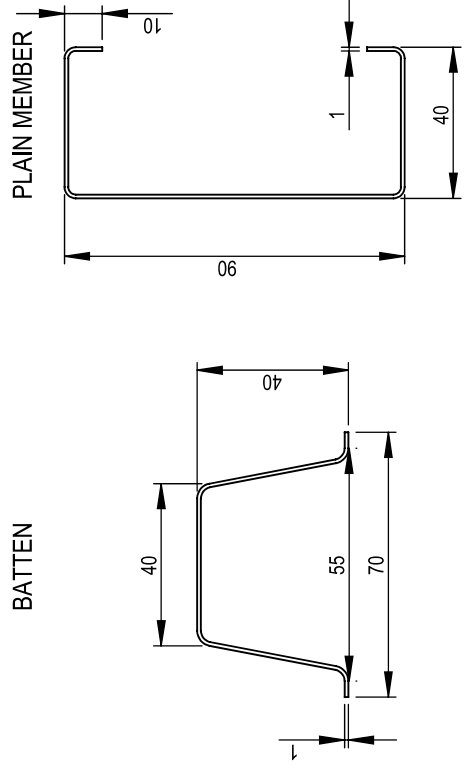

STRUCTURAL STEEL WORK
 LIGHT GAUGE GALVANISED STEEL GRADE S550
 STANDARD 89S41

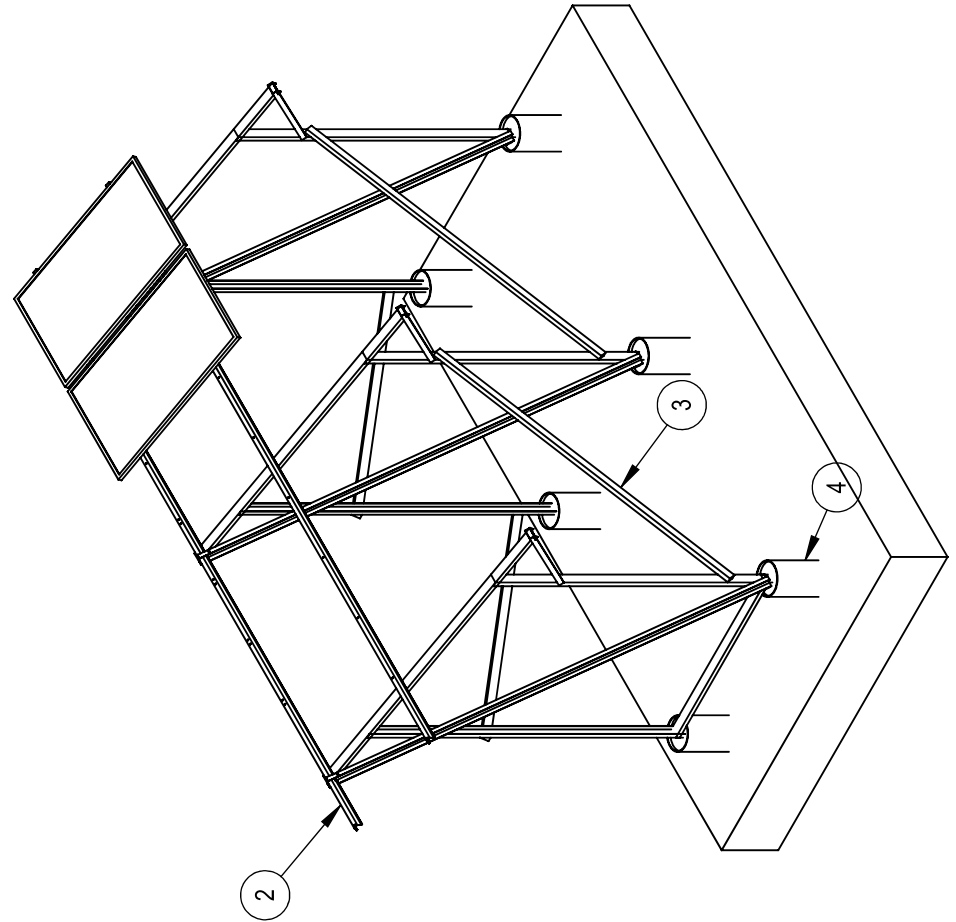

NOTES:

1. All dimensions in mm.

REVISION:

Rev	Description	By	Date

PROJECT:

WASH-COMMUNITY RESILIENCE BUILDING IN
 LIVELIHOOD & DISASTER RISK MANAGEMENT
 (REBUILD) IN TANA-RIVER COUNTY

TITLE:

DIMENSION AND LAYOUT
 STEEL STRUCTURE
 DETAILS

PART NO:

SCALE: 1:100

DRWG NO:

CLIENT:



INTERNATIONAL COMMITTEE
 FOR DEVELOPMENT OF PEOPLE
 NAIROBI OFFICE # 117
 MANYANI EAST ROAD, OFF
 JAMES GICHURU, LAVINGTON,
 NAIROBI, KENYA
 Email: kenya@cisp-ngo.org

NOTES:

1. All dimensions in mm.

REVISION:

Rev	Description	By	Date

TITLE:

DIMENSION AND LAYOUT
DETAILS

PART NO:

SCALE: 1:40

DRWG NO:

CLIENT:



INTERNATIONAL COMMITTEE
FOR DEVELOPMENT OF PEOPLE
NAIROBI OFFICE # 117
MANYANI EAST ROAD, OFF
JAMES GICHURU, LAVINGTON,
NAIROBI , KENYA
Email: kenya@cisp-ngo.org

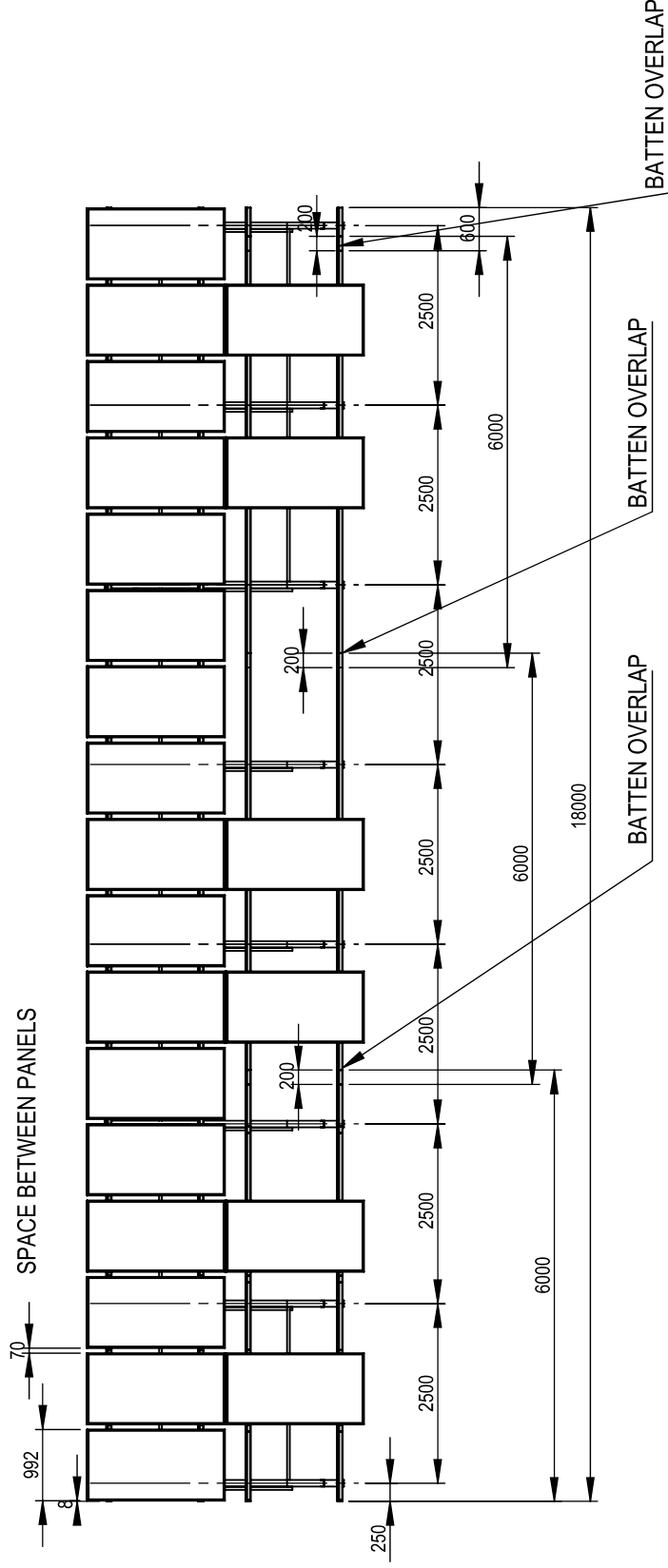

PLAN VIEW

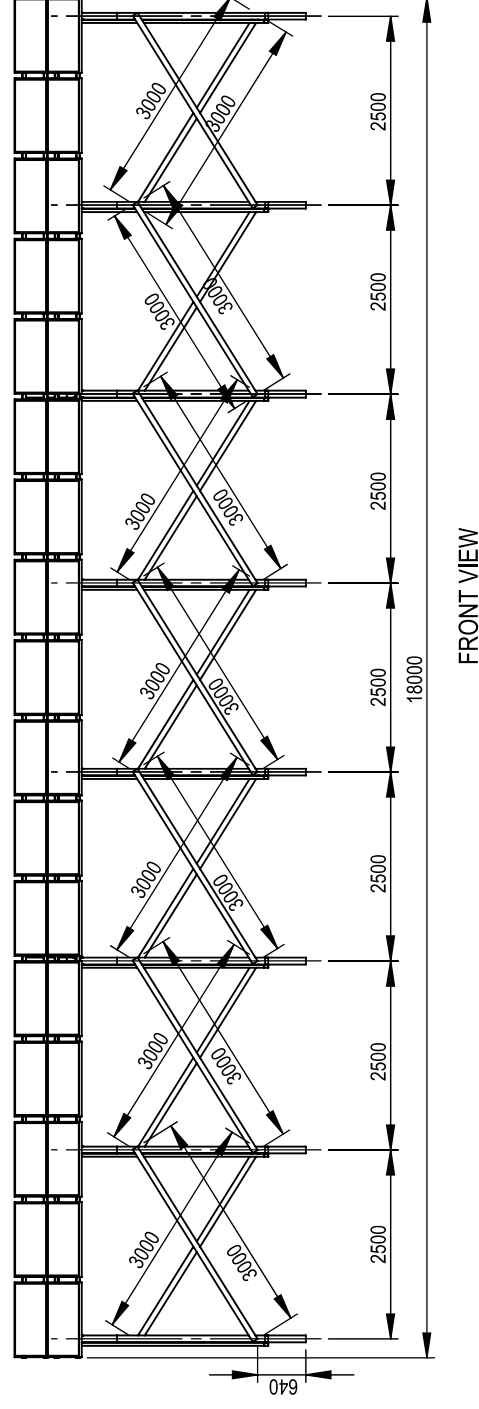

FRONT VIEW

NOTES:

1. All dimensions in mm.

DETAIL C: YSM 300

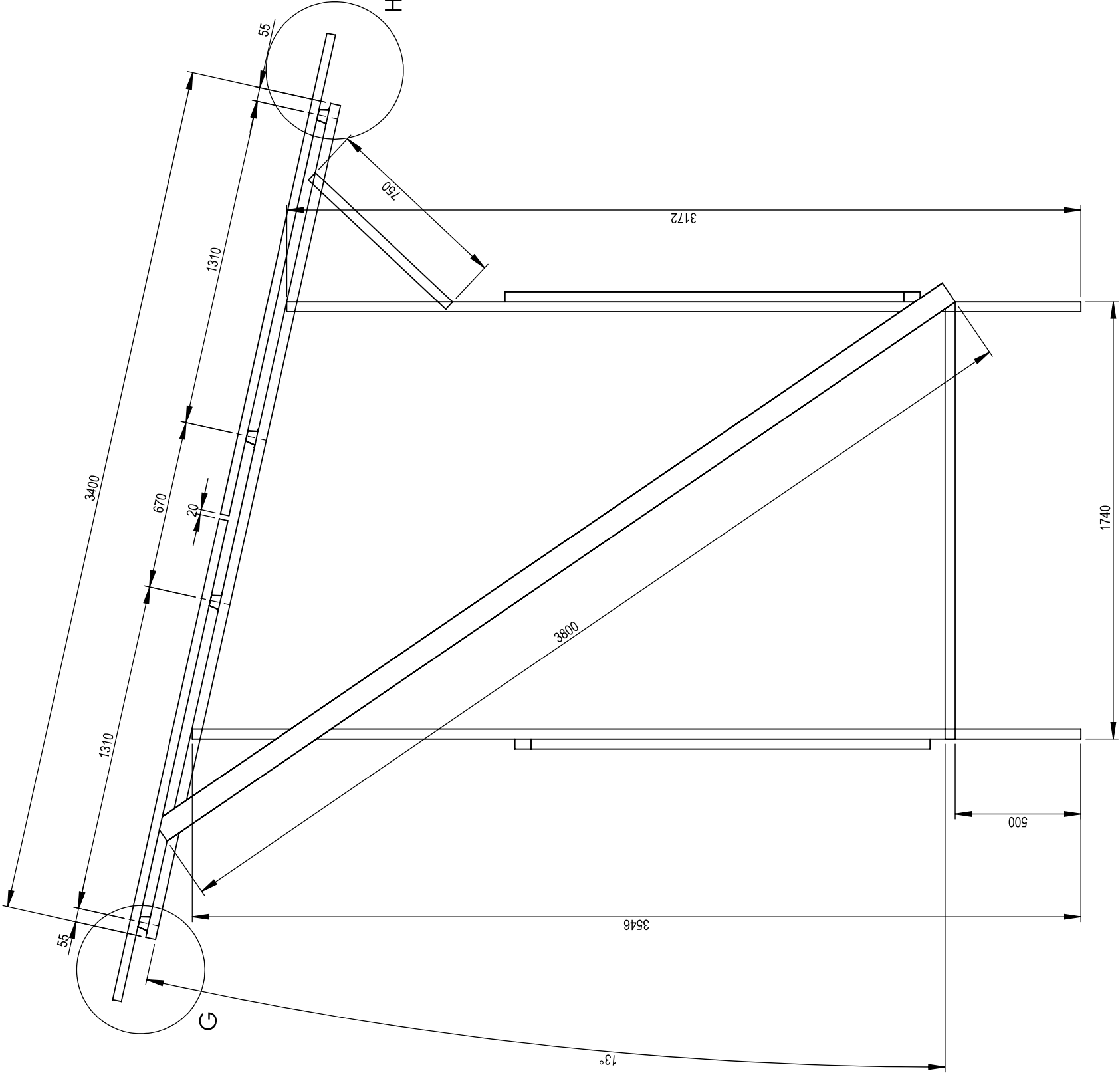
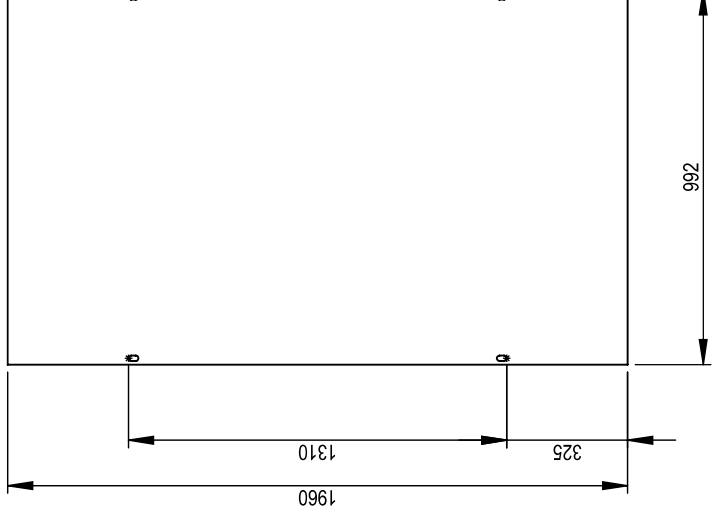

SIDE VIEW

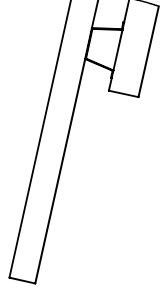

DETAIL G
SCALE 1 : 10

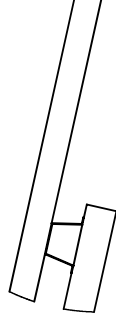

DETAIL H
SCALE 1 : 10

REVISION:

Rev	Description	By	Date

PROJECT:

TITLE:

DIMENSION AND LAYOUT
DETAILS

PART NO:

SCALE: 1:40

DRWG NO:

CLIENT:



INTERNATIONAL COMMITTEE
FOR DEVELOPMENT OF PEOPLE
NAIROBI OFFICE # 117
MANYANI EAST ROAD, OFF
JAMES GICHURU, LAVINGTON,
NAIROBI , KENYA
Email: kenya@cisp-ngo.org